

CAIMIEXPORT

LUXURY HARDWARE

Sotto undermount

COMPANY

QUALITY AND EXPERIENCE



Our company was founded in 1964.

In the early years of our activity we dedicated ourselves to the design and production of aluminum components exclusively for some of the most renowned companies in the world of furniture.

close collaboration with important players in the sector and the continuous drive to find original solution to customer needs have enabled us to acquire distinctive skills in designing, developing and industrializing unique components.

Today we are able to offer a wide range of patented products, designed to make exclusive: wardrobe cabinet, living room, kitchen, bathroom and office furniture.

We search for solution to guarantee innovative and exclusive products: this is the only way we can improve what we offer our customers and propose solution that use aluminum in an innovative way

CAIMI Srl

sede legale: Via Villafranca, 4/23

60122 Ancona (AN) – IT

sede produttiva: Via San Primo, 25

Lurago d'Erba (CO) – IT

sede amministrativa: Via Provinciale, 31

22060 Novedrate (CO) – IT

Cod. Fiscale e P.IVA 08485910965

Cap. Sociale: 15.000,00 int. vers.

R.E.A. Ancona: AN-214329

Telefono: +39 031 3510111

Fax: +39 031 3510410

eMail: infocaimi@caimiexport.it

PEC: caimisrl@pec.it

CAIMIEXPORT
LUXURY HARDWARE

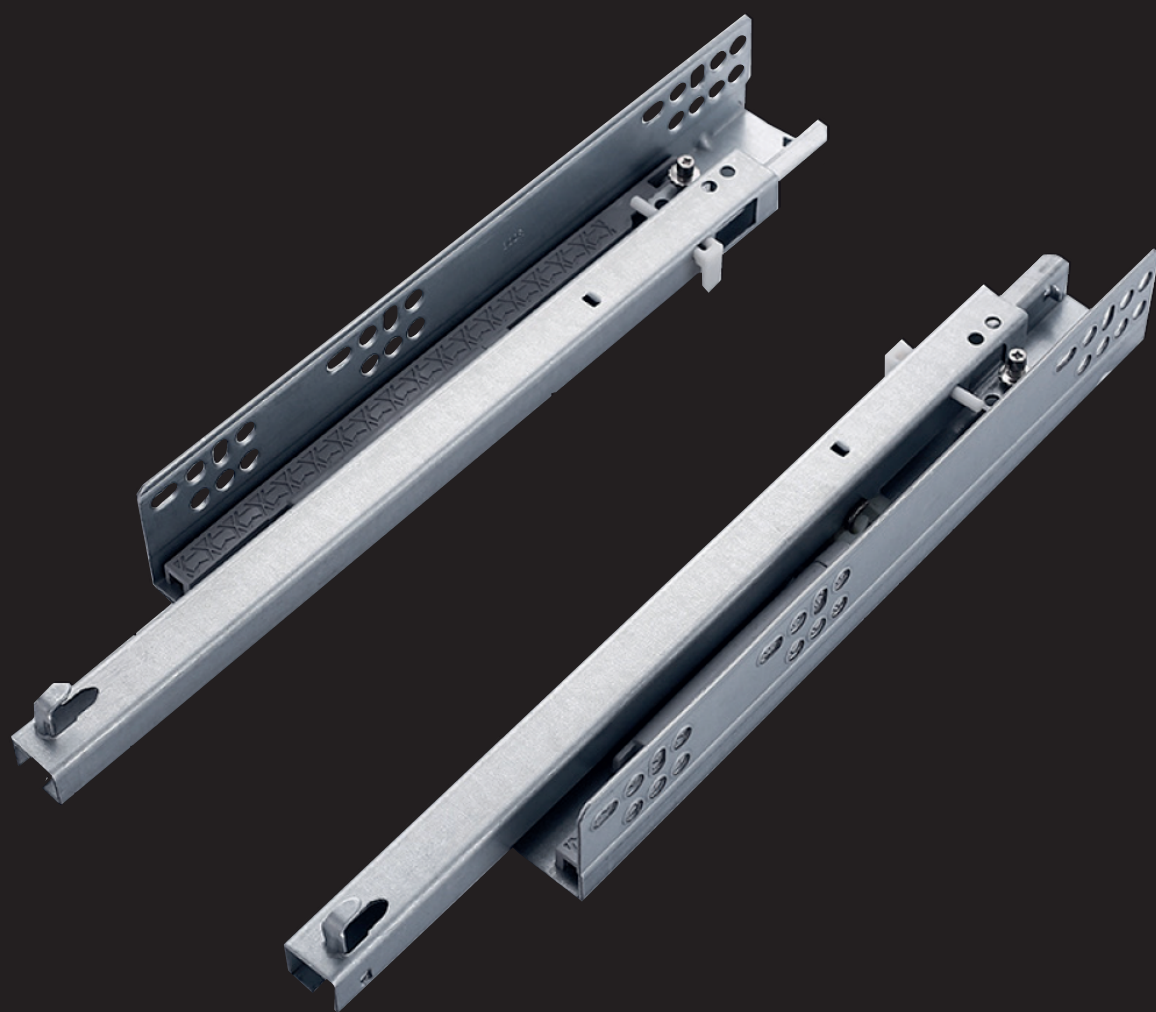

Sotto undermount partial extraction

CAIMIEXPORT

LUXURY HARDWARE

Standard version



Product description

- Guide undermount partial extraction with pin
- Material: cold rolled steel
- Profile thickness: 1.0*1.0mm
- Length: 250-550mm
- Excellent smoothness with calibrated rollers
- 3 types of closure: standard – cushioned – push open
- Vertical adjustment wheel
- Integrated anti-lift system
- Load capacity: 20kg

Standard Version

Codice	Descrizione
4SH250EP	SLIDE PARTIAL EXT. WITH PIN 250mm
4SH300EP	SLIDE PARTIAL EXT. WITH PIN 300mm
4SH350EP	SLIDE PARTIAL EXT. WITH PIN 350mm
4SH400EP	SLIDE PARTIAL EXT. WITH PIN 400mm
4SH450EP	SLIDE PARTIAL EXT. WITH PIN 450mm
4SH500EP	SLIDE PARTIAL EXT. WITH PIN 500mm
4SH550EP	SLIDE PARTIAL EXT. WITH PIN 550mm

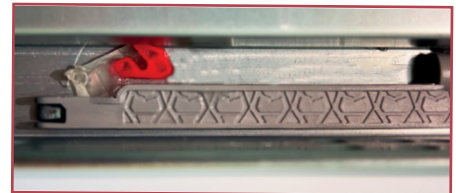

Soft-close Version

Codice	Descrizione
4SH250SP	SLIDE PARTIAL EXT. SOFT-CLOSE WITH PIN 250mm
4SH300SP	SLIDE PARTIAL EXT. SOFT-CLOSE WITH PIN 300mm
4SH350SP	SLIDE PARTIAL EXT. SOFT-CLOSE WITH PIN 350mm
4SH400SP	SLIDE PARTIAL EXT. SOFT-CLOSE WITH PIN 400mm
4SH450SP	SLIDE PARTIAL EXT. SOFT-CLOSE WITH PIN 450mm
4SH500SP	SLIDE PARTIAL EXT. SOFT-CLOSE WITH PIN 500mm
4SH550SP	SLIDE PARTIAL EXT. SOFT-CLOSE WITH PIN 550mm

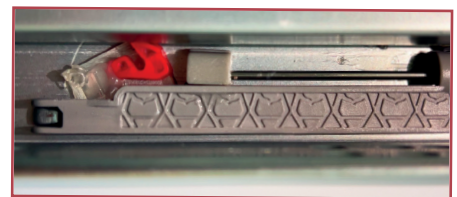

push open Version

Codice	Descrizione
4SH250PP	SLIDE PARTIAL EXT. PUSH-OPEN WITH PIN 250mm
4SH300PP	SLIDE PARTIAL EXT. PUSH-OPEN WITH PIN 300mm
4SH350PP	SLIDE PARTIAL EXT. PUSH-OPEN WITH PIN 350mm
4SH400PP	SLIDE PARTIAL EXT. PUSH-OPEN WITH PIN 400mm
4SH450PP	SLIDE PARTIAL EXT. PUSH-OPEN WITH PIN 450mm
4SH500PP	SLIDE PARTIAL EXT. PUSH-OPEN WITH PIN 500mm
4SH550PP	SLIDE PARTIAL EXT. PUSH-OPEN WITH PIN 550mm



Sotto undermount partial extraction

CAIMIEXPORT**LUXURY HARDWARE**

Technical specification

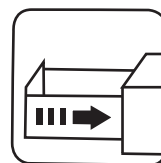
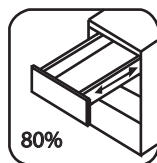

Fixing instructions

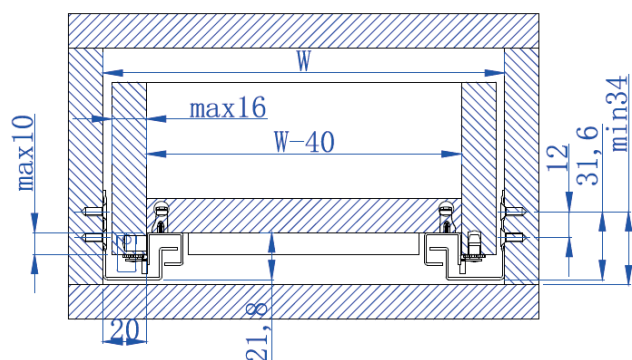

NL: Nominal guide length
LT: Internal depth of the cabinet
W: Internal cabinet width
SKL: Drawer depth
X: Front panel thickness
RT: Push open activation space
dp: Drilling depth

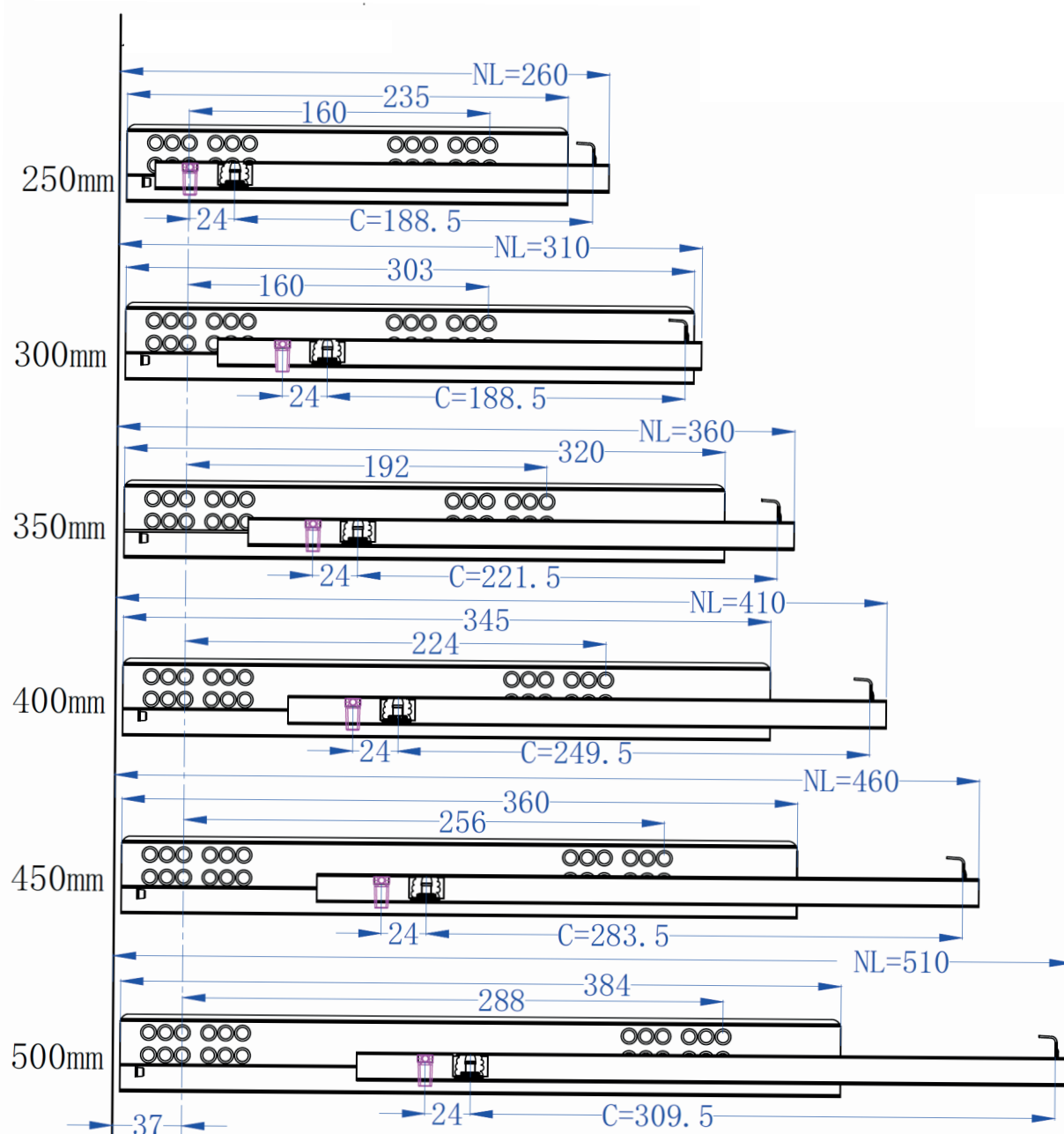

Drawer drilling

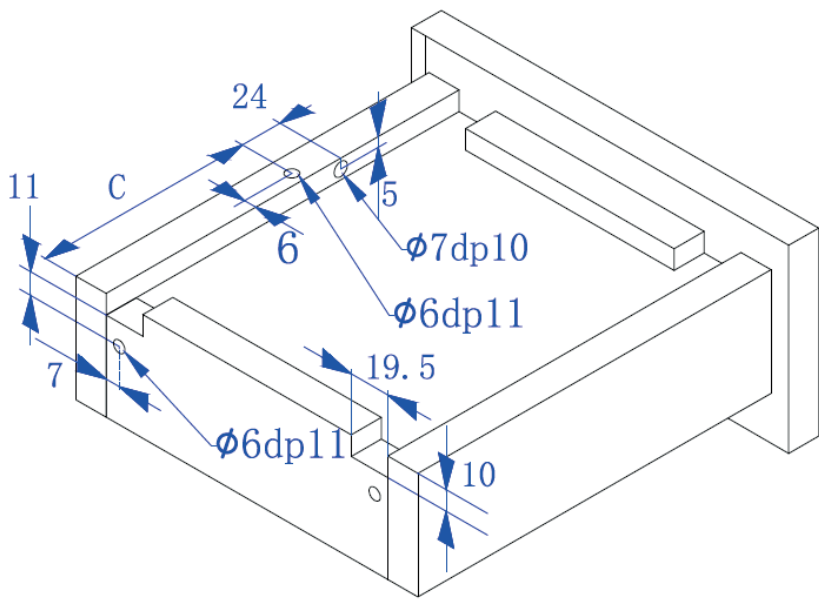

- NL: Nominal guide length
- LT: Internal depth of the cabinet
- W: Internal cabinet width
- SKL: Drawer depth
- X: Front panel thickness
- RT: Push open activation space
- dp: Drilling depth

Drawer with front

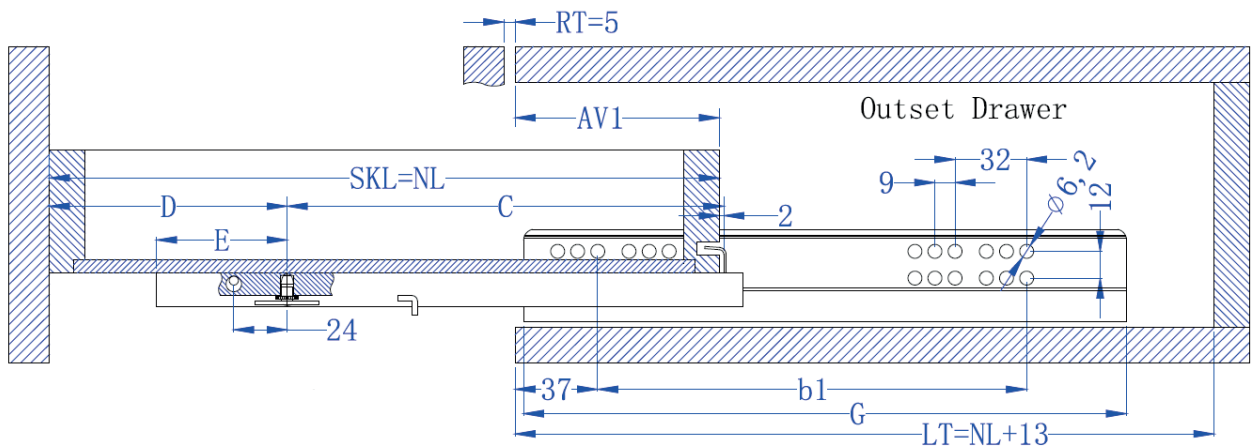

Internal drawer

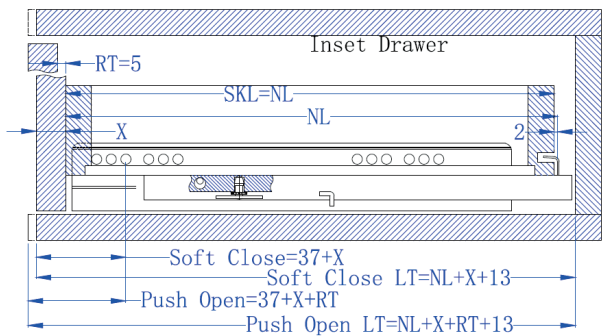

NL	LT	b1	C	D	E	G	AV1
250	>263	160	188.5	61.5	42.5	235	89.5
300	>313	160	188.5	111.5	58.5	303	
320	>333	192	221.5	98.5		290	
350	>363	192	221.5	128.5		320	
380	>393	224	249.5	130.5	58.5	325	106.5
400	>413	224	283.5	186.5		345	
420	>431	224	283.5	136.5		330	125.1
450	>463	256	283.5	166.5		360	
480	>493	256	309.5	170.5		364	
500	>513	288	309.5	190.5		384	
520	>533	288	338.5	181.5		375	
550	>563	320	338.5	211.5		405	

Product image

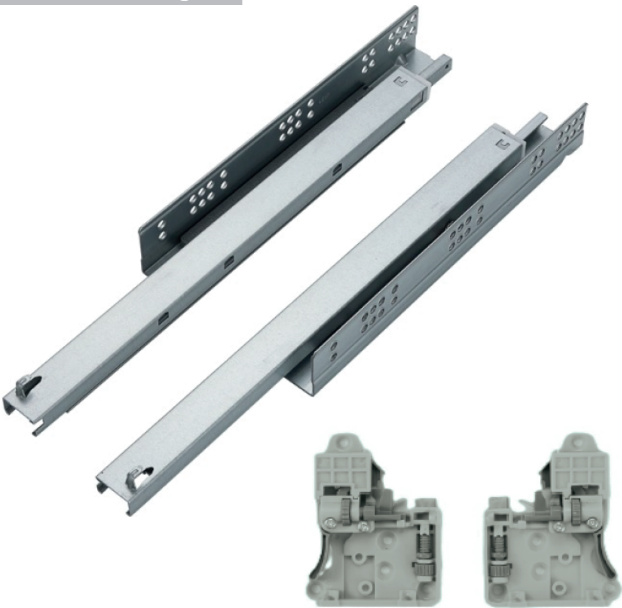

Product Description

- Guide undermount partial extraction with handles
- Material: cold rolled steel
- Profile thickness: 1.8*1.4*1.0mm
- Length: 250-550mm
- Excellent smoothness with calibrated rollers
- 2 types of closure: soft close – push open
- Handles with vertical - horizontal adjustment
- Load capacity: 30kg

Soft-close version

Codes	Description
4FB250S2	SLIDE FULL EXT. SOFT-CLOSE WITH HANDLES 250mm
4FB300S2	SLIDE FULL EXT. SOFT-CLOSE WITH HANDLES 300mm
4FB350S2	SLIDE FULL EXT. SOFT-CLOSE WITH HANDLES 350mm
4FB400S2	SLIDE FULL EXT. SOFT-CLOSE WITH HANDLES 400mm
4FB450S2	SLIDE FULL EXT. SOFT-CLOSE WITH HANDLES 450mm
4FB500S2	SLIDE FULL EXT. SOFT-CLOSE WITH HANDLES 500mm

Versione push open

Codes	Description
4FB250P2	SLIDE FULL EXT. PUSH-OPEN WITH HANDLES 250mm
4FB300P2	SLIDE FULL EXT. PUSH-OPEN WITH HANDLES 300mm
4FB350P2	SLIDE FULL EXT. PUSH-OPEN WITH HANDLES 350mm
4FB400P2	SLIDE FULL EXT. PUSH-OPEN WITH HANDLES 400mm
4FB450P2	SLIDE FULL EXT. PUSH-OPEN WITH HANDLES 450mm
4FB500P2	SLIDE FULL EXT. PUSH-OPEN WITH HANDLES 500mm

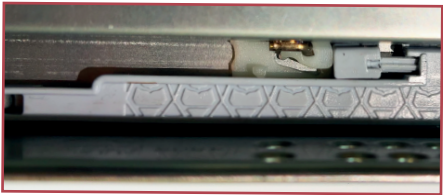
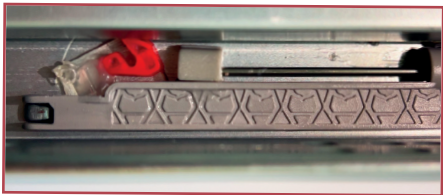

Sotto undermount full extraction

Tecnical specification

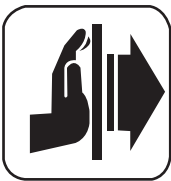
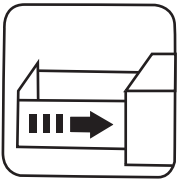
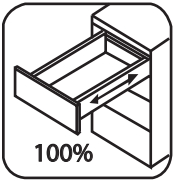

Fixing instructions

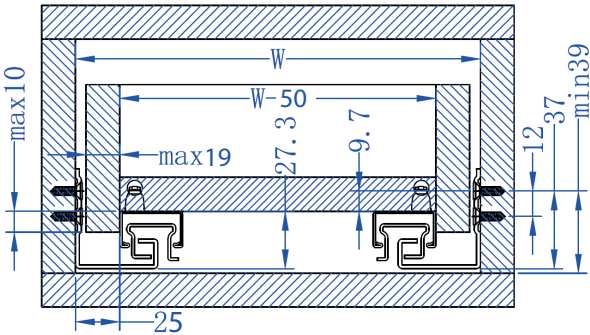

NL: Nominal guide length
LT: Internal depth of the cabinet
W: Internal cabinet width
SKL: Drawer depth
X: Front panel thickness
RT: Push open activation space
dp: Drilling depth

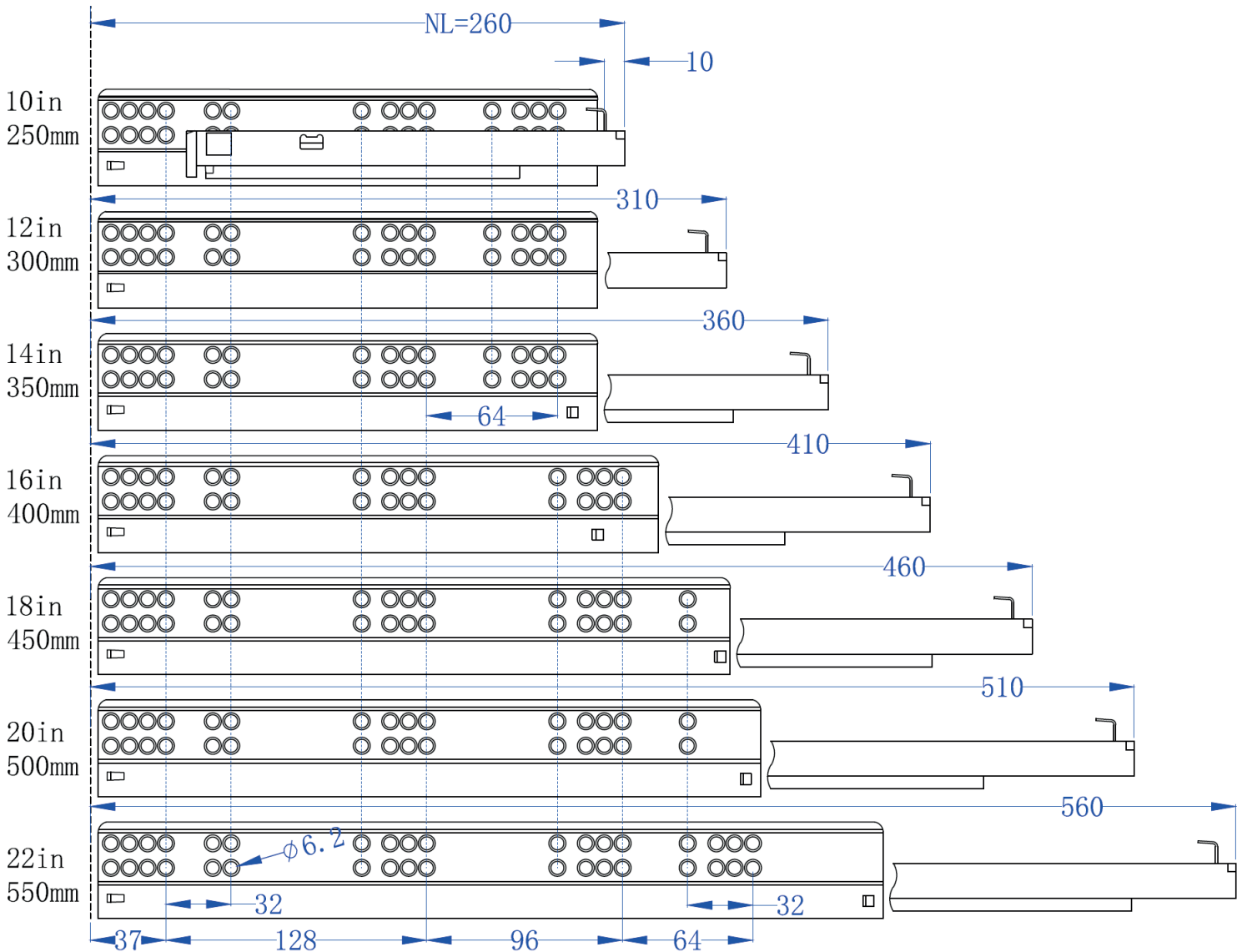

Sotto undermount full extraction

CAIMIEXPORT

LUXURY HARDWARE

Drawer drilling

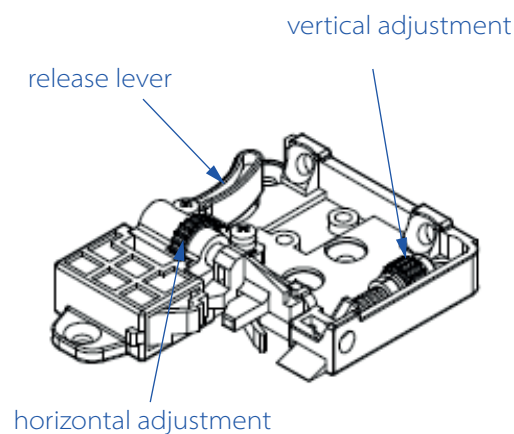
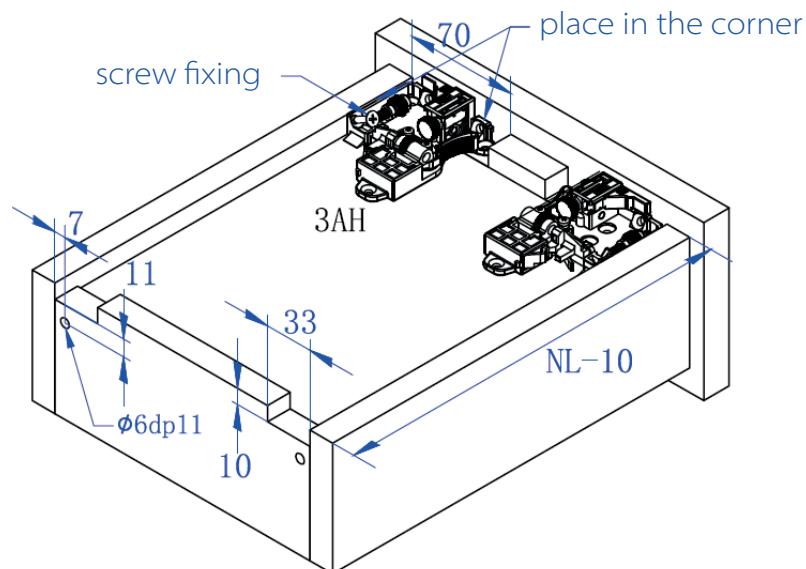

Drawer with front

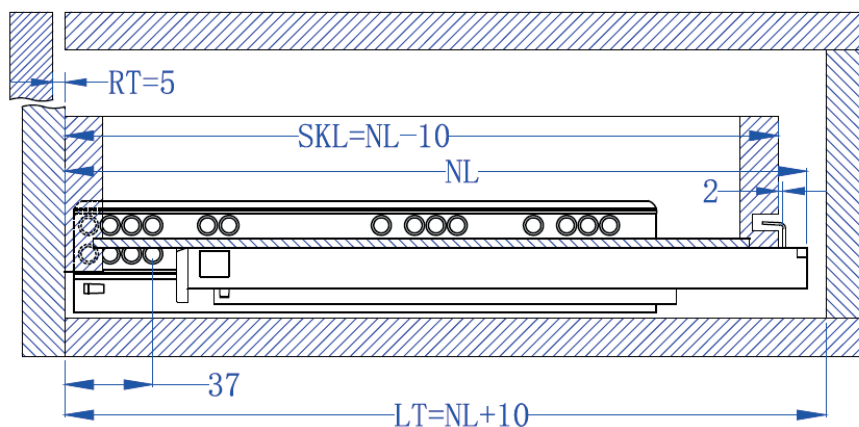

Internal drawer

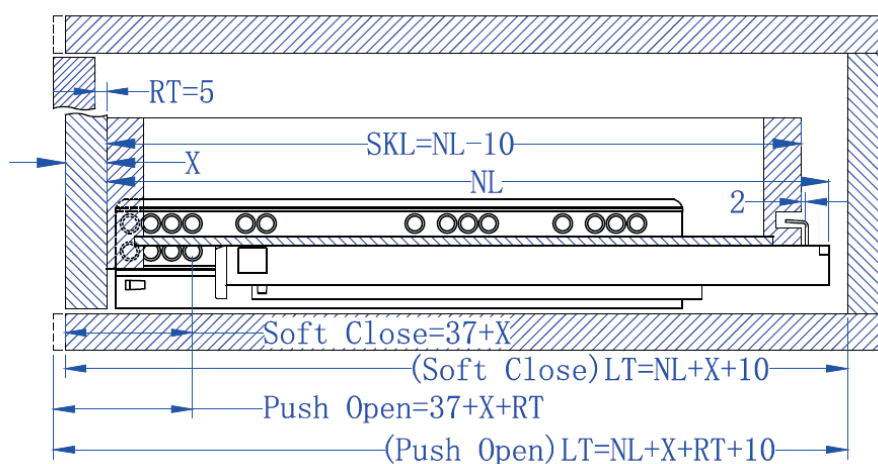

NL: Nominal guide length
 LT: Internal depth of the cabinet
 W: Internal cabinet width
 SKL: Drawer depth
 X: Front panel thickness
 RT: Push open activation space
 dp: Drilling depth

Packaging and palletizing detail partial extraction slides

Length (mm)	Set./Box.	box weight (Kg)	Box Dimention (cm)	box./tier	n° tiers	box./pallet	Pallet weight (Kg)	Pallet dimention (cm)
250	15	9	27* 23*14	17	6	102	915	120* 100* 98
300	15	10	32* 23*14	14	6	84	876	120* 100* 98
350	15	11	37* 23*14	13	6	78	846	120* 100* 98
400	15	11	42* 23*14	10	6	60	724	120* 100* 98
450	15	12	47* 23*14	10	6	60	754	120* 100* 98
500	15	13	52* 23*14	9	6	54	739	120* 100* 98
550	15	14	57* 23*14	8	6	48	640	120* 100* 98

Packaging and palletizing detail full extension slides

Length (mm)	Set./Box.	box weight (Kg)	Dimention box (cm)	box./ties	n° tiers	box./pallet	weight Pallet (Kg)	Dimention Pallet (cm)
250	10	14	33* 28* 12	10	7	70	977	120* 100* 99
300	10	15	39* 28* 12	9	7	63	949	120* 100* 99
350	10	16	44* 28* 12	8	7	56	935	120* 100* 99
400	10	18	49* 28* 12	7	8	56	1.010	120* 100* 110
450	10	20	54* 28* 12	6	8	48	990	120* 100* 110
500	10	21	59* 28* 12	6	8	48	1.042	120* 100* 110
550	10	24	64* 28* 12	5	8	40	986	120* 100* 110

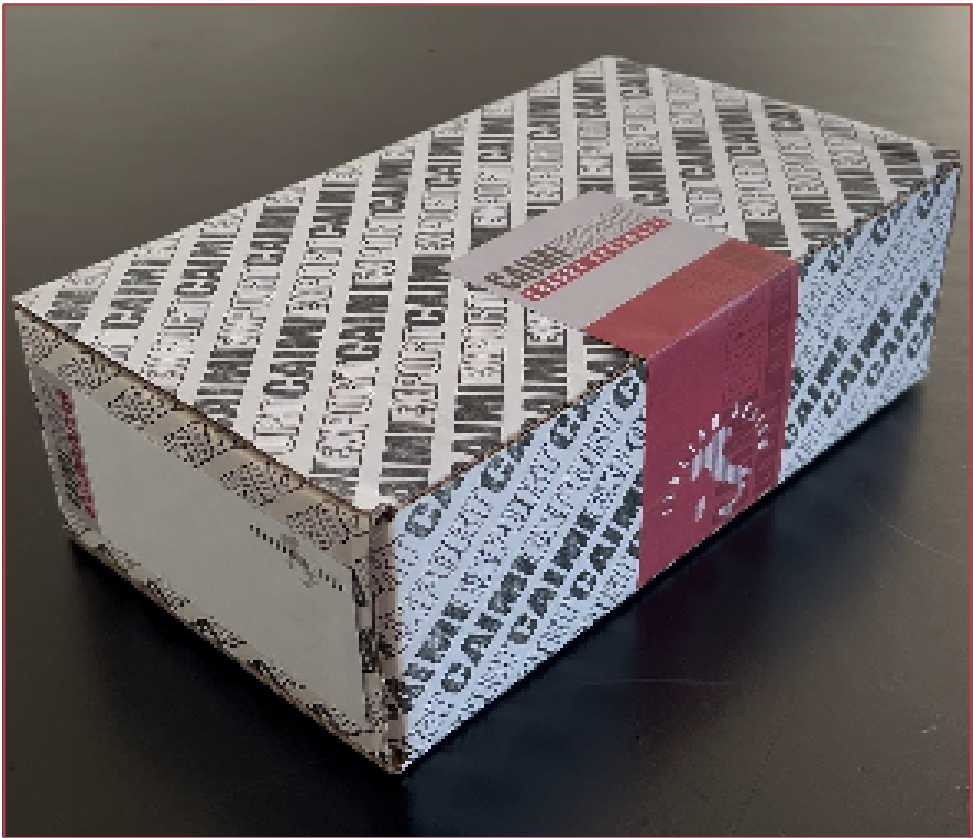

Note

CAIMIEXPORT

LUXURY HARDWARE

CAIMIEXPORT

LUXURY HARDWARE



CAIMI Srl
Registered office: Via Villafranca, 4/23
60122 Ancona (AN) – IT
Production site: Via San Primo, 25
Lurago d'Erba (CO) – IT
Administrative headquarters: Via Provinciale, 31
22060 Novedrate (CO) – IT

Cod. Fiscale e P.IVA 08485910965
Cap. Sociale: 15.000,00 int. vers.
R.E.A. Ancona: AN-214329
Phone: +39 031 3510111
Fax: +39 031 3510410
eMail: infocaimi@caimiexport.it
PEC: caimisrl@pec.it