

CAIMIEXPORT

LUXURY HARDWARE

Quattro clip hinge soft close

COMPANY

QUALITY AND EXPERIENCE



Our company was founded in 1964.

In the early years of our activity we dedicated ourselves to the design and production of aluminum components exclusively for some of the most renowned companies in the world of furniture.

close collaboration with important players in the sector and the continuous drive to find original solution to customer needs have enabled us to acquire distinctive skills in designing, developing and industrializing unique components.

Today we are able to offer a wide range of patented products, designed to make exclusive: wardrobe cabinet, living room, kitchen, bathroom and office furniture.

We search for solution to guarantee innovative and exclusive products: this is the only way we can improve what we offer our customers and propose solution that use aluminum in an innovative way

CAIMI Srl

sede legale: Via Villafranca, 4/23
60122 Ancona (AN) – IT

sede produttiva: Via San Primo, 25
Lurago d'Erba (CO) – IT

sede amministrativa: Via Provinciale, 31
22060 Novedrate (CO) – IT

Cod. Fiscale e P.IVA 08485910965

Cap. Sociale: 15.000,00 int. vers.

R.E.A. Ancona: AN-214329

Telefono: +39 031 3510111

Fax: +39 031 3510410

eMail: infocaimi@caimiexport.it

PEC: caimisrl@pec.it

CAIMIEXPORT
LUXURY HARDWARE



CAIMIEXPORT
LUXURY HARDWARE

Quattro clip hinge soft close-special angles

CAIMIEXPORT
LUXURY HARDWARE

Advance soft-close technology

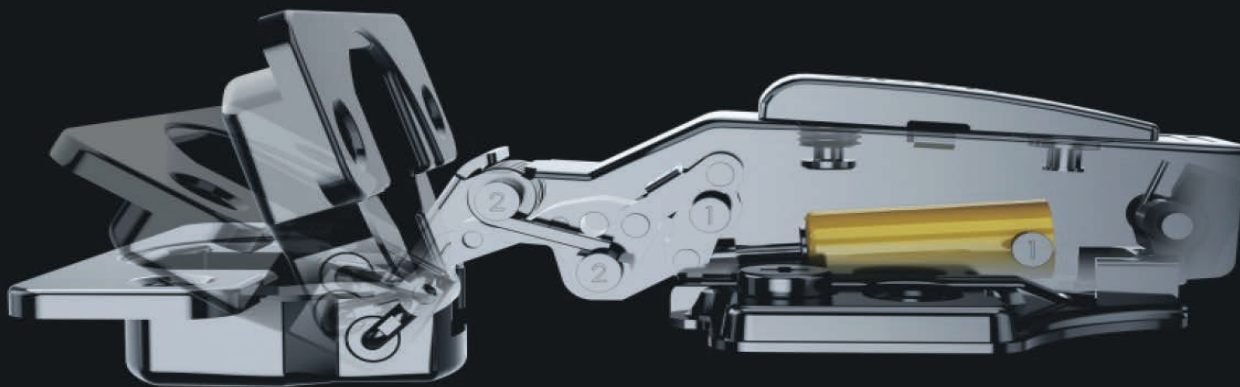

Hinge quality soft close technology for a progressive and silent closure, eliminating door slamming and preserving the future's integrity over time.

High-resistance materials to ensure robustness, corrosion resistance, and structural stability.

Tested to withstand cycles, ensuring superior durability and reliability.

Versatibel application: idea for kitchens, bathrooms, bedrooms, and custom furniture, where quietness and fluid movement are essential requirement. Elegance that makes no noise

Hinge adjustment and Recommended Hinges Based on door Weight and Height

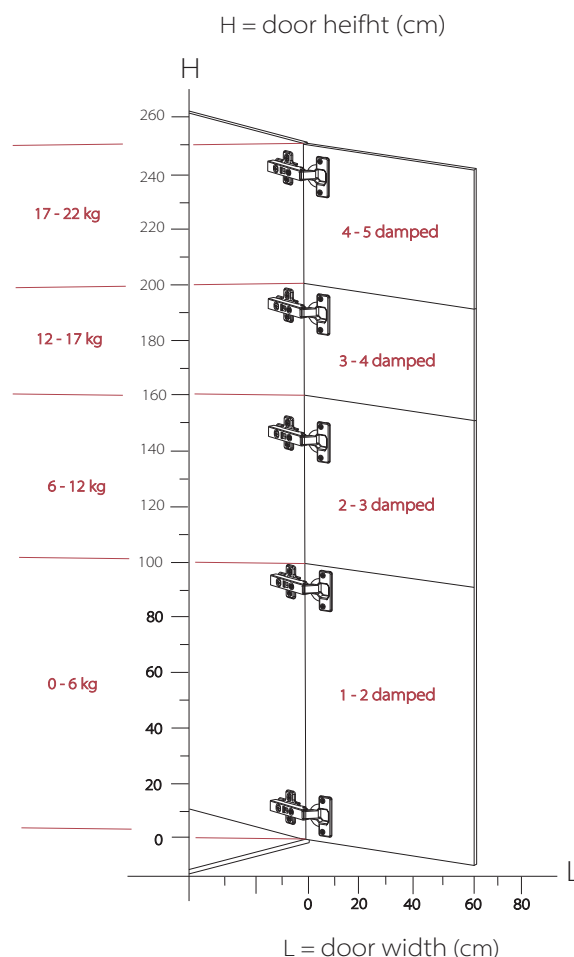
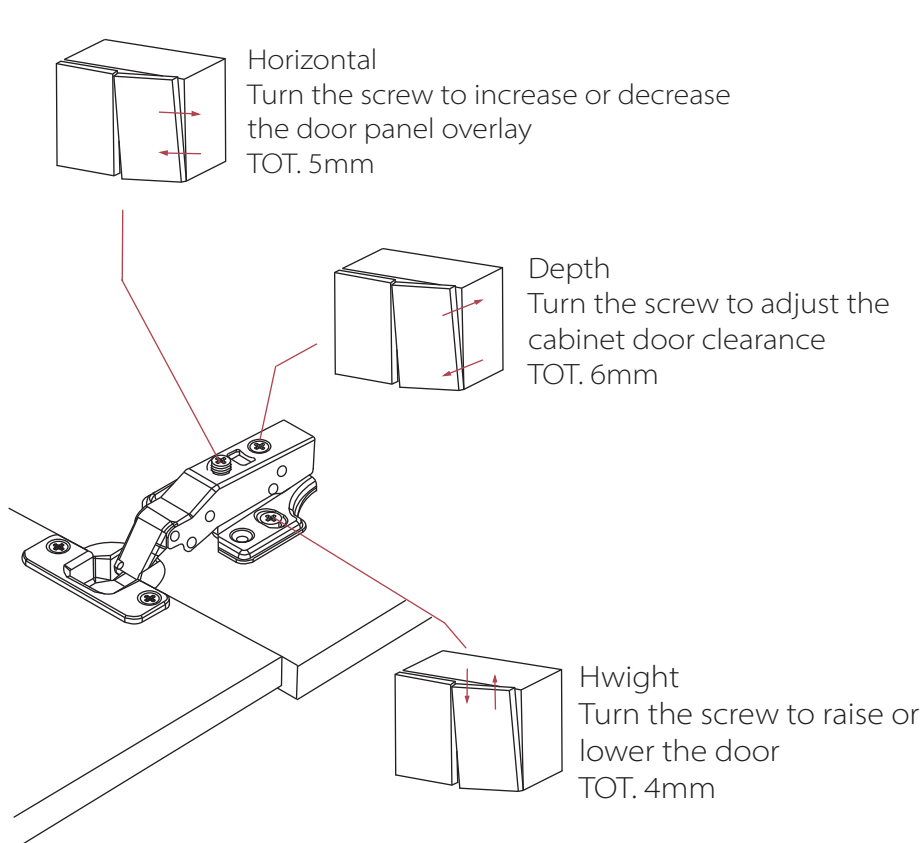

Quattro clip hinge soft close-special angles

CAIMIEXPORT
LUXURY HARDWARE

Product image



Product description

- Cup diameter: 35 mm
- Cup depth: 11 mm
- Max. Opening angle: 105 °
- Door drilling distance (k): 3-7 mm
- Thickness of door (t): 16-26 mm
- Precise depth adjustment by Cochlea
- Complete program of fixing system
- Cup hole distance: 45-48-52mm
- Strong structure for high performance
- 2way opening to avoid the door damaging

Drilling for cup

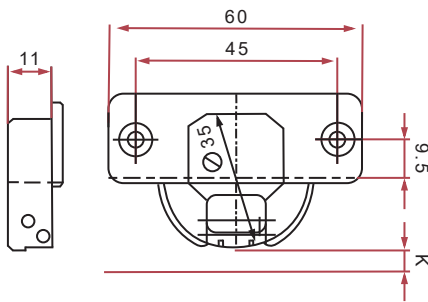

B-45

Full Overlay

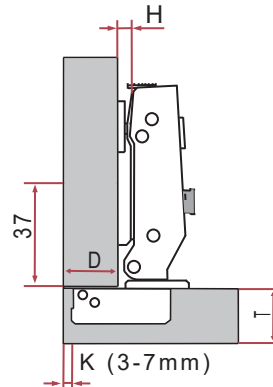

$$H=14+K-D$$

$\begin{smallmatrix} D \\ H \end{smallmatrix} K$	3	4	5	6	7
0	17	18	19	20	21
2	15	16	17	18	19

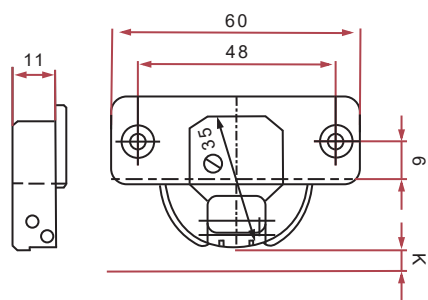

S-48

Half Overlay

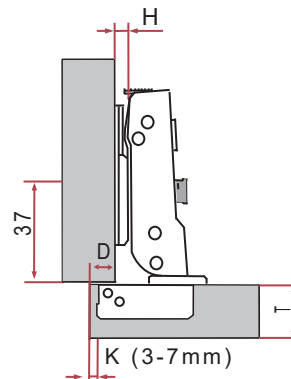

$$H=4+K-D$$

$\begin{smallmatrix} D \\ H \end{smallmatrix} K$	3	4	5	6	7
0	7	8	9	10	11
2	5	6	7	8	9

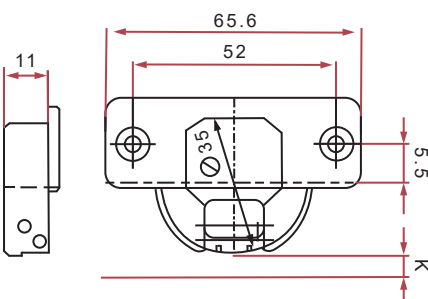

H-52

Inset

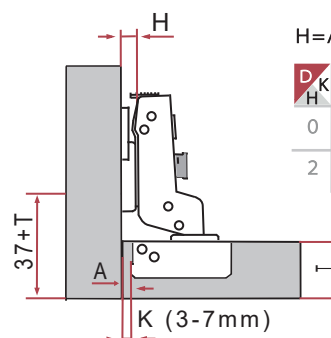

$$H=A+K-5$$

$\begin{smallmatrix} D \\ H \end{smallmatrix} K$	3	4	5	6	7
0	2	1	0	-1	-2
2	4	3	2	1	0

Quattro clip hinge soft close-special angles

Cup Installation

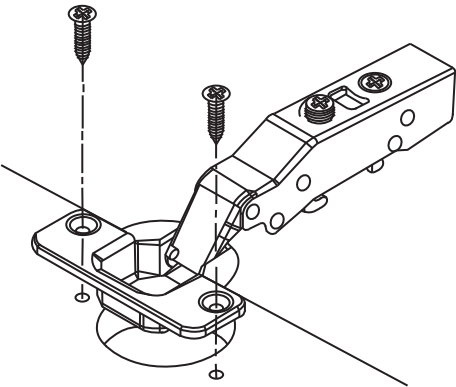

Screw on

- W

4X16
- W

Euro screw

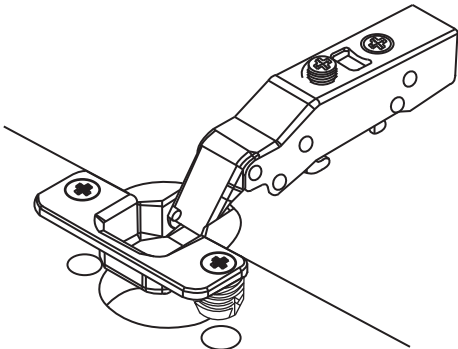

Press in

- C

M8 Dowel
- D

M10 Dowel

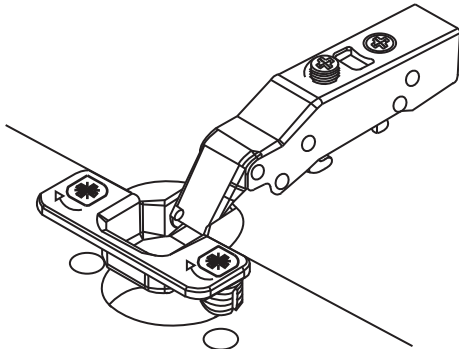

Expanding

- C

M10 Dowel

Minimum Reveal Table

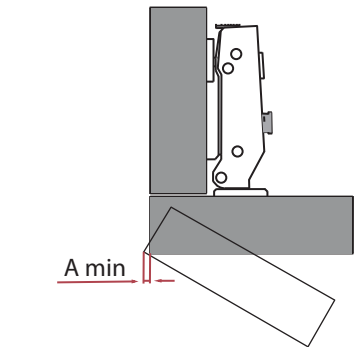

<div>A</div> <div>K</div> <div>T</div>	16	17	18	19	20	21	22	23	24	25	26
3	0.9	1.1	1.5	1.8	2.3	2.8	3.6	4.3	5.2	6.0	6.9
4	0.8	1.1	1.4	1.8	2.2	2.7	3.3	4.0	4.7	5.5	6.5
5	0.8	1.0	1.3	1.7	2.1	2.5	3.1	3.7	4.4	5.1	5.9
6	0.8	1.0	1.3	1.6	1.9	2.3	2.7	3.3	3.8	4.5	5.2
7	0.7	1.0	1.3	1.6	1.9	2.3	2.7	3.3	3.8	4.5	5.2

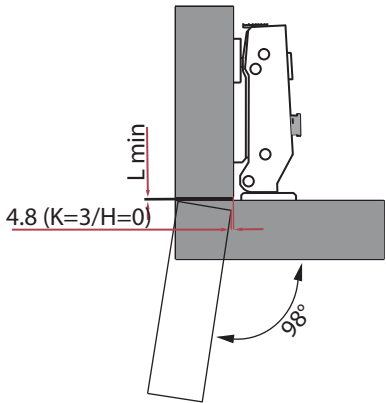

<div>L</div> <div>K</div> <div>T</div>	16	17	18	19	20	21	22	23	24	25	26
3	0.0	0.0	0.0	0.0	0.0	0.0	0.0	0.0	0.0	0.0	0.0
4	0.0	0.0	0.0	0.0	0.0	0.0	0.0	0.0	0.0	0.0	0.0
5	0.0	0.0	0.0	0.1	0.2	0.3	0.4	0.6	0.7	0.9	1.0
6	0.6	0.8	1.0	1.1	1.2	1.3	1.4	1.6	1.8	1.9	2.0
7	1.6	1.8	2.0	2.1	2.2	2.3	2.4	2.6	2.8	2.9	3.0

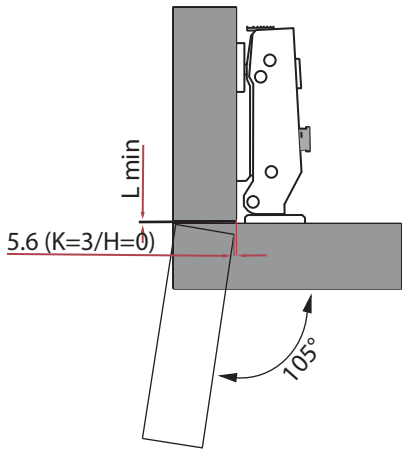

<div>L</div> <div>K</div> <div>T</div>	16	17	18	19	20	21	22	23	24	25	26
3	0.0	0.0	0.0	0.0	0.2	0.5	0.7	1.0	1.4	1.5	1.8
4	0.1	0.4	0.6	0.9	1.2	1.5	1.7	2.0	2.2	2.5	2.7
5	1.1	1.4	1.6	1.9	2.2	2.4	2.7	2.9	3.2	3.5	3.7
6	2.1	2.3	2.6	2.9	3.1	3.4	3.6	3.9	4.2	4.4	4.7
7	3.1	3.3	3.6	3.8	4.1	4.3	4.6	4.9	5.1	5.4	6.5

Quattro clip hinge soft close-special angles

CAIMIEXPORT

LUXURY HARDWARE

Item code

▲ Full Overlay



▲ Half Overlay



▲ Inset



B 1H000B0AWN
S 1H000S0AWN
H 1H000H0AWN

1H008B0AWN
1H008S0AWN
1H008H0AWN

1H015B0AWN
1H015S0AWN
1H015H0AWN

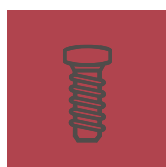

B 1H000B0AEN
S 1H000S0AEN
H 1H000H0AEN

1H008B0AEN
1H008S0AEN
1H008H0AEN

1H015B0AEN
1H015S0AEN
1H015H0AEN

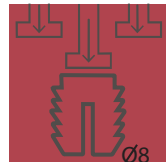

B 1H000B0ACN
S 1H000S0ACN
H 1H000H0ACN

1H008B0ACN
1H008S0ACN
1H008H0ACN

1H015B0ACN
1H015S0ACN
1H015H0ACN

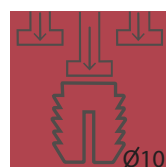

B 1H000B0ADN
S 1H000S0ADN
H 1H000H0ADN

1H008B0ADN
1H008S0ADN
1H008H0ADN

1H015B0ADN
1H015S0ADN
1H015H0ADN

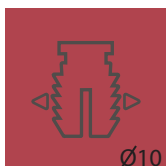

B 1H000B0AXN
S 1H000S0AXN
H 1H000H0AXN

1H008B0AXN
1H008S0AXN
1H008H0AXN

1H015B0AXN
1H015S0AXN
1H015H0AXN

Drilling for cup

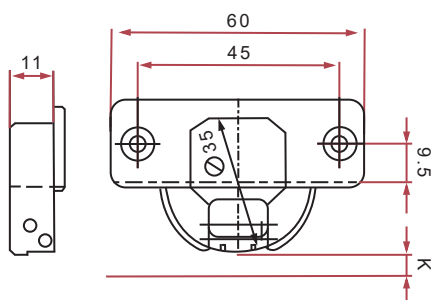

B-45

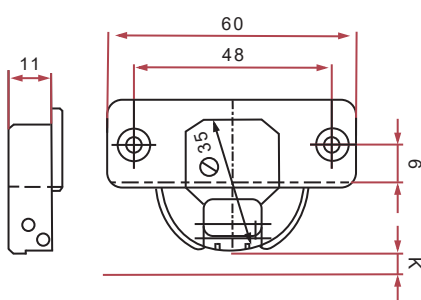

S-48

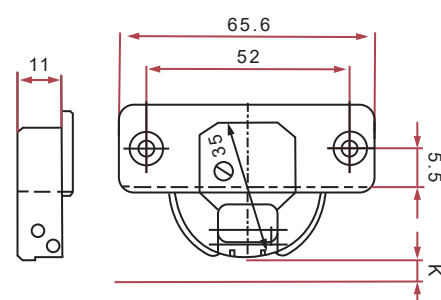

H-52

Product image

Product description



- Slanted-neck hinge for easy installation
- Cup diameter: 35 mm
- Cup depth: 11 mm
- Max. opening angle: 105°
- Door drilling distance (k): 3-7 mm
- Door thickness (t): 16-26 mm
- Complete range of fixing options
- Cup hole distance: 45-48-52 mm
- Strong structure for high performance
- Two-way opening to prevent door damage

Drilling for cup

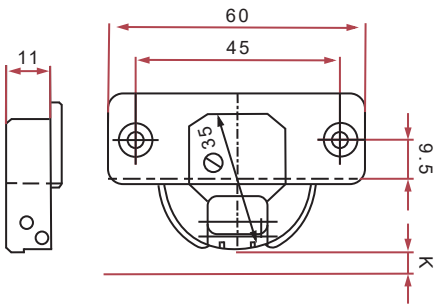

30°

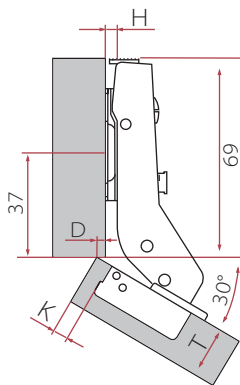

30°

<div><div>D</div><div>H</div><div>K</div></div>	3	4	5	6	7
0	0.3	1.1	2	2.9	3.7
2	-1,7	-0.9	0	0.9	1.7

B-45

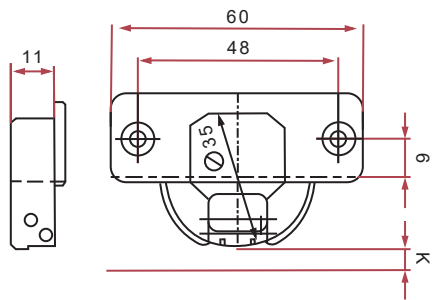

45°

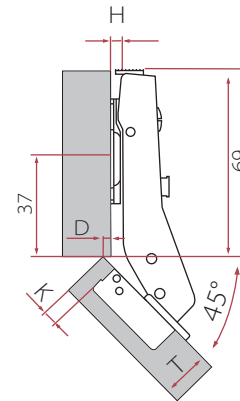

45°

<div><div>D</div><div>H</div><div>K</div></div>	3	4	5	6	7
0	0.6	1.3	2	2.7	3.4
2	-1.4	-0.7	0	0.7	1.4

S-48

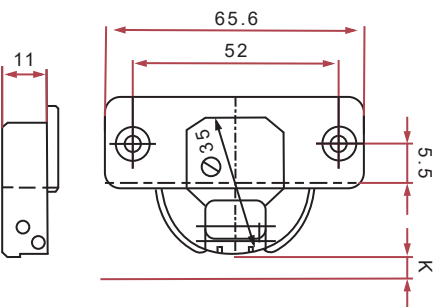

90°

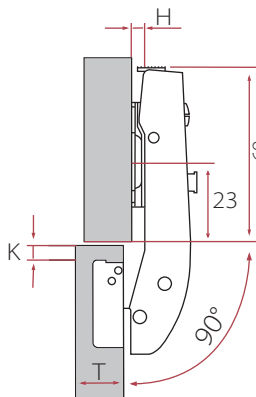

90°

<div><div>A</div><div>H</div><div>K</div></div>	4	5	6		
0	2	2	2		
2	0	0	0		

H-52

Quattro clip hinge soft close-special angles

CAIMIEXPORT
LUXURY HARDWARE

Cup Installation

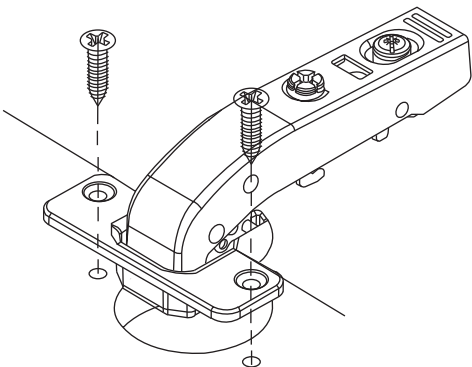

Screw on

W 4X16

W Euro screw

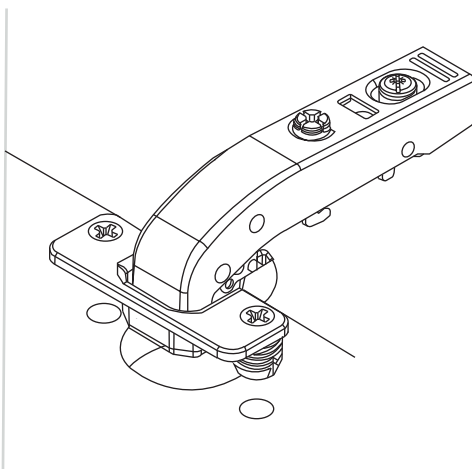

Press in

C M8 Dowel

D M10 Dowel

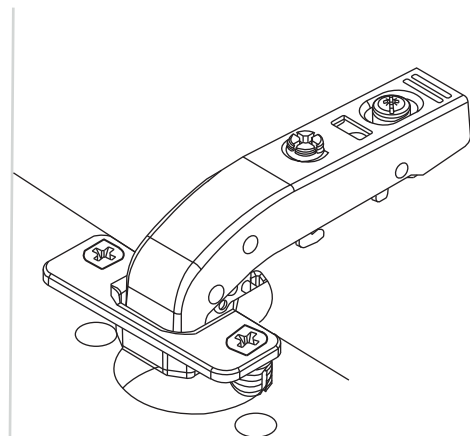

Expanding

C M10 Dowel

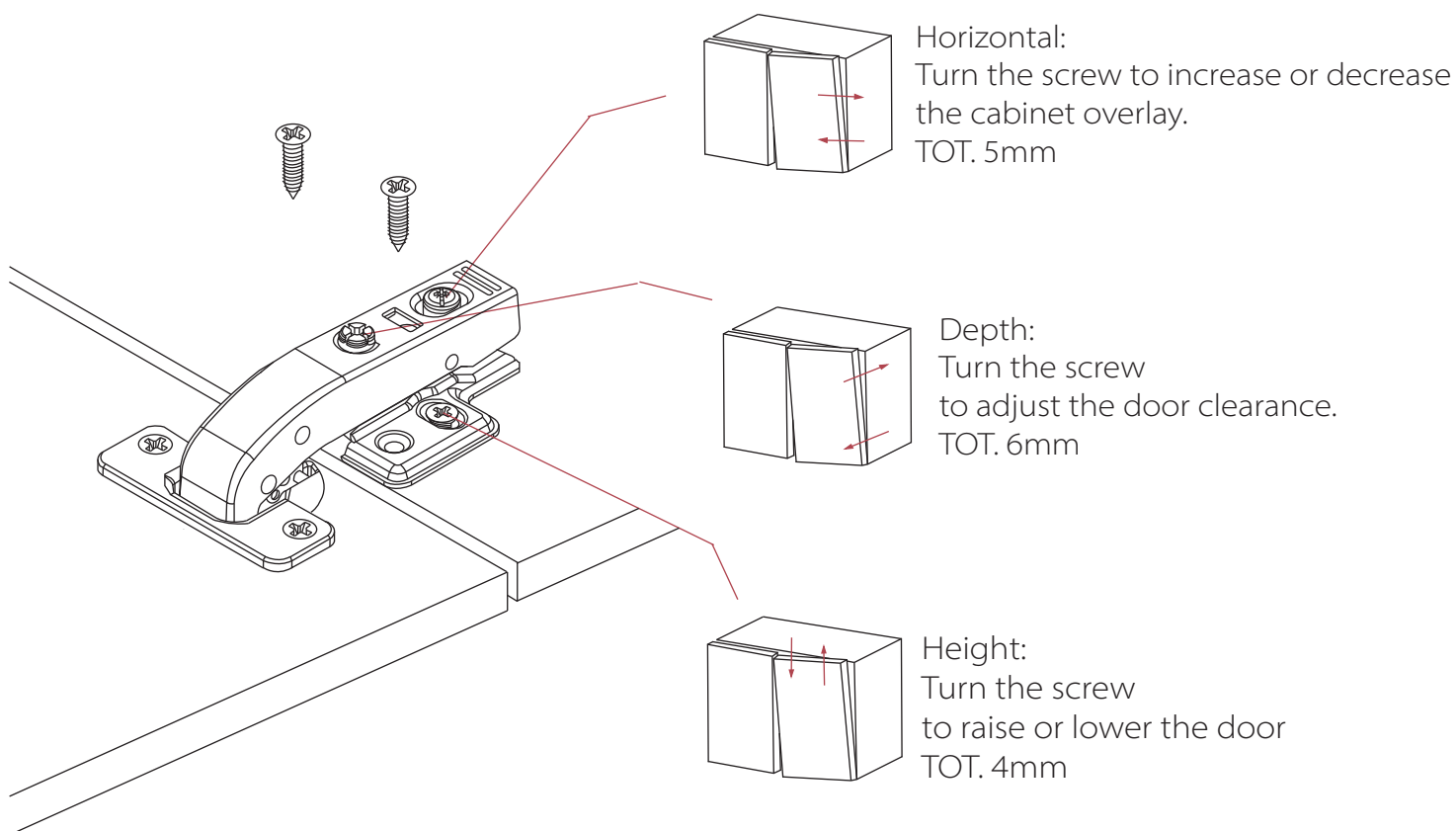

Quattro clip hinge soft close-special angles

CAIMIEXPORT

LUXURY HARDWARE

Item code

30°



45°



90°

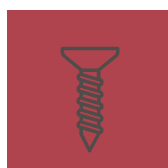

B 1H030B0AWN
S 1H030S0AWN
H 1H030H0AWN

1H045B0AWN
1H045S0AWN
1H045H0AWN

1H090B0AWN
1H090S0AWN
1H090H0AWN

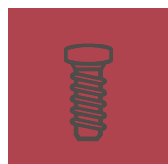

B 1H030B0AEN
S 1H030S0AEN
H 1H030H0AEN

1H045B0AEN
1H045S0AEN
1H045H0AEN

1H090B0AEN
1H090S0AEN
1H090H0AEN

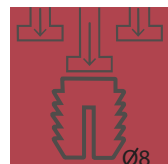

B 1H030B0ACN
S 1H030S0ACN
H 1H030H0ACN

1H045B0ACN
1H045S0ACN
1H045H0ACN

1H090B0ACN
1H090S0ACN
1H090H0ACN

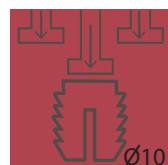

B 1H030B0ADN
S 1H030S0ADN
H 1H030H0ADN

1H045B0ADN
1H045S0ADN
1H045H0ADN

1H090B0ADN
1H090S0ADN
1H090H0ADN

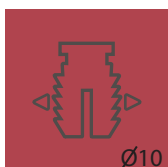

B 1H030B0AXN
S 1H030S0AXN
H 1H030H0AXN

1H045B0AXN
1H045S0AXN
1H045H0AXN

1H090B0AXN
1H090S0AXN
1H090H0AXN

Drilling for cup

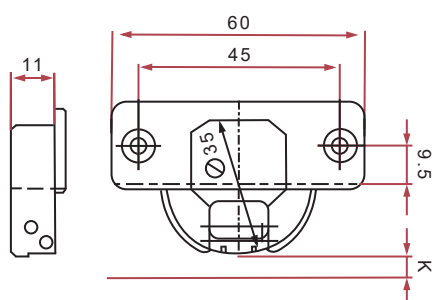

B-45

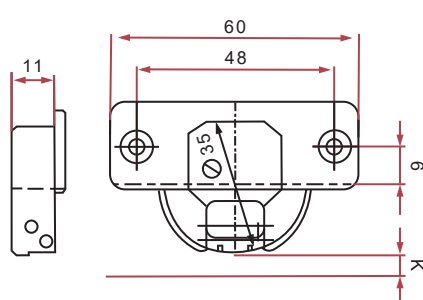

S-48

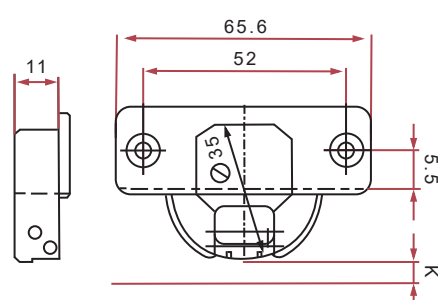

H-52

Quattro clip hinge soft close - 165°

CAIMIEXPORT

LUXURY HARDWARE

Product image



Product description

- Hinge for a special opening 165°
- Cup diameter: 35 mm
- Cup depth: 11,4 mm
- Max. opening angle: 165 °
- Door drilling distance (k): 3-7 mm
- Door thickness (t): 16-26 mm
- Complete range of fixing options
- Cup hole distance: 45-48-52mm
- Strong structure for high performance
- Two-way opening to prevent door damage

Drilling for cup

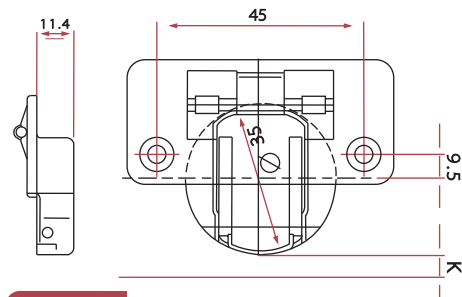

B-45

Full Overlay

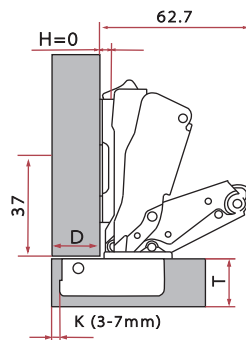
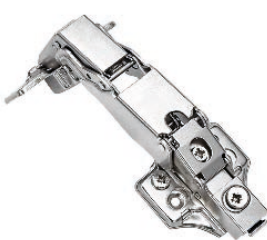

$$H=14+K-D$$

$\frac{D}{H}$	3	4	5	6	7
0	17	18	19	20	21
2	15	16	17	18	19

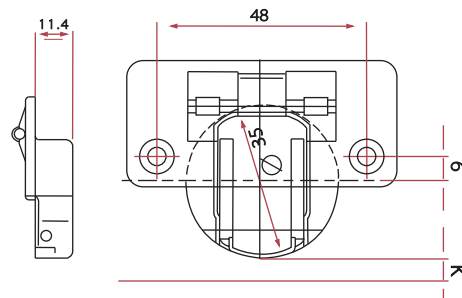

S-48

Half Overlay

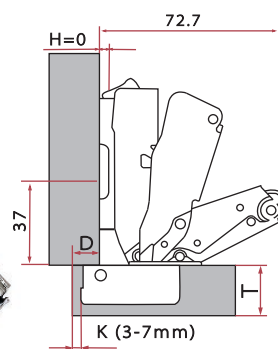
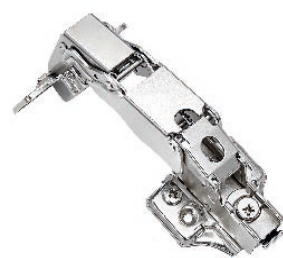

$$H=4+K-D$$

$\frac{D}{H}$	3	4	5	6	7
0	7	8	9	10	11
2	5	6	7	8	9

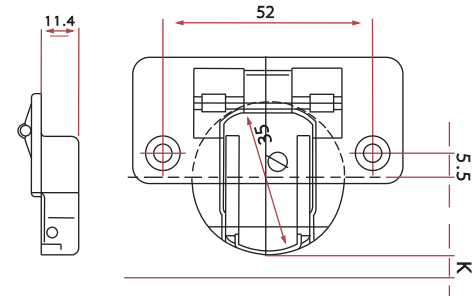

H-52

inset

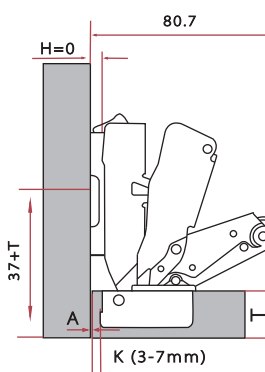
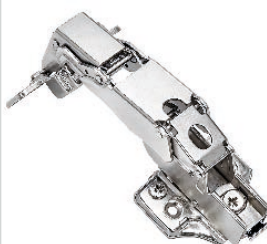

$$H=A+K-4$$

$\frac{D}{H}$	3	4	5	6	7
0	1	0	-1	-2	-3
2	3	2	1	0	-1

Quattro clip hinge soft close - 165°

Cup Installation

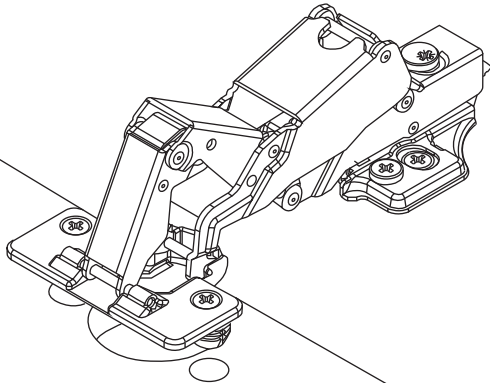
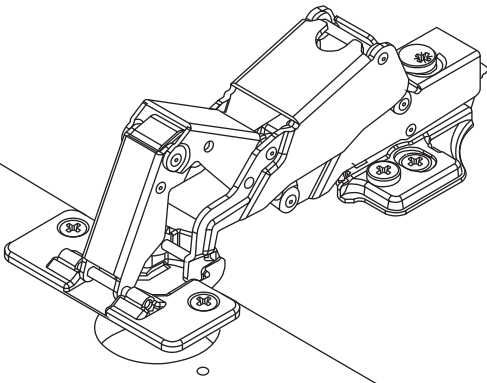

Screw on

- W** 4X16
- W** Euro Screw

Press in

- C** M8 Dowel
- D** M10 Dowel

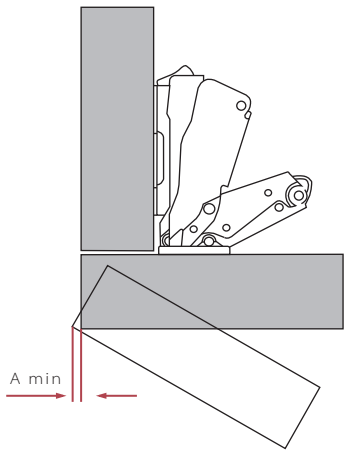

<div>A</div> <div>K</div> <div>T</div>	16	17	18	19	20	21	22	23	24	25	26
3	0.0	0.0	0.10	0.23	0.47	0.61	0.90	2.95	3.65	4.72	5.64
4	0.0	0.0	0.07	0.18	0.37	0.53	0.90	1.85	3.08	3.92	4.85
5	0.0	0.0	0.0	0.13	0.29	0.58	1.07	1.73	2.48	3.30	4.16
6	0.0	0.0	0.0	0.10	0.22	0.46	0.85	1.39	2.05	2.79	3.58
7	0.0	0.0	0.0	0.07	0.19	0.38	0.69	1.14	1.71	2.39	3.10

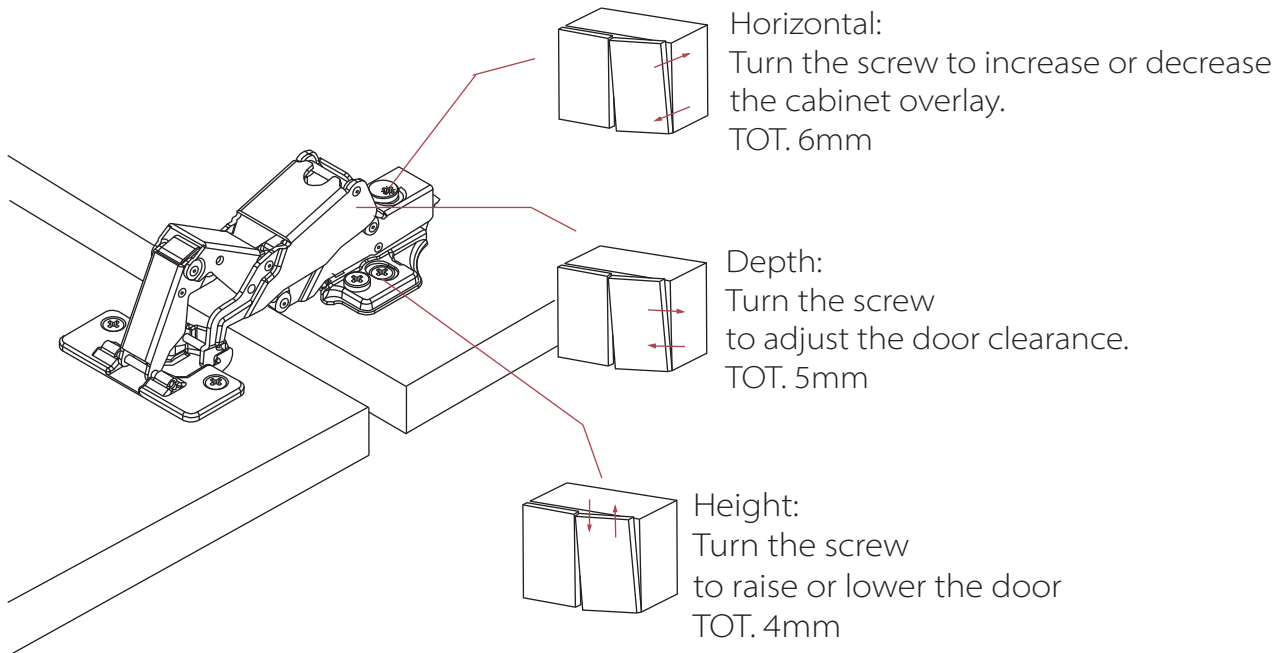

Quattro clip hinge soft close - 165°

CAIMIEXPORT
LUXURY HARDWARE

Item code

Full Overlay

Half Overlay

Inset

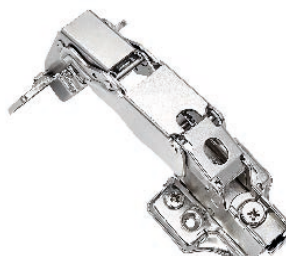
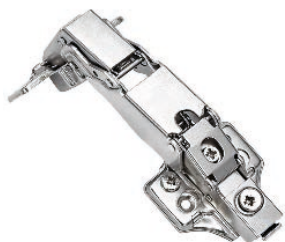

B 1H000B0BWN
S 1H000S0BWN
H 1H000H0BWN

1H008B0BWN
1H008S0BWN
1H008H0BWN

1H015B0BWN
1H015S0BWN
1H015H0BWN

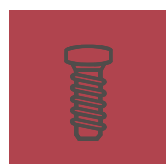

B 1H000B0BEN
S 1H000S0BEN
H 1H000H0BEN

1H008B0BEN
1H008S0BEN
1H008H0BEN

1H015B0BEN
1H015S0BEN
1H015H0BEN

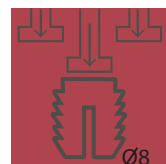

B 1H000B0BCN
S 1H000S0BCN
H 1H000H0BCN

1H008B0BCN
1H008S0BCN
1H008H0BCN

1H015B0BCN
1H015S0BCN
1H015H0BCN

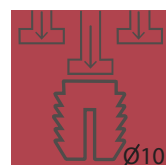

B 1H000B0BDN
S 1H000S0BDN
H 1H000H0BDN

1H008B0BDN
1H008S0BDN
1H008H0BDN

1H015B0BDN
1H015S0BDN
1H015H0BDN

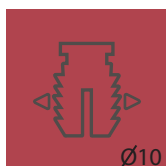

B 1H000B0BXN
S 1H000S0BXN
H 1H000H0BXN

1H008B0BXN
1H008S0BXN
1H008H0BXN

1H015B0BXN
1H015S0BXN
1H015H0BXN

Drilling for cup

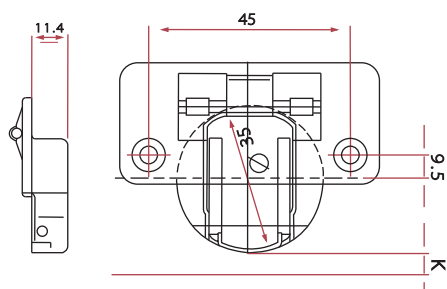

B-45

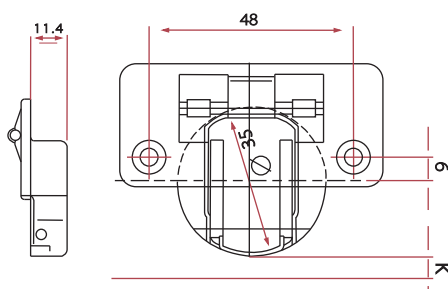

S-48

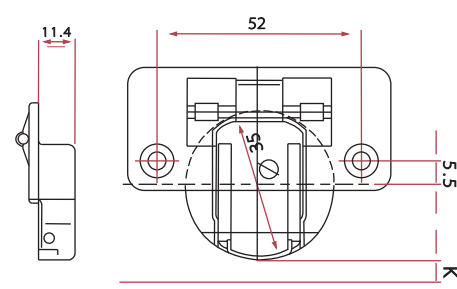

H-52

Quattro standard mounting plates

CAIMIEXPORT

LUXURY HARDWARE

Cruciform plate for wood screws

Heights - codes

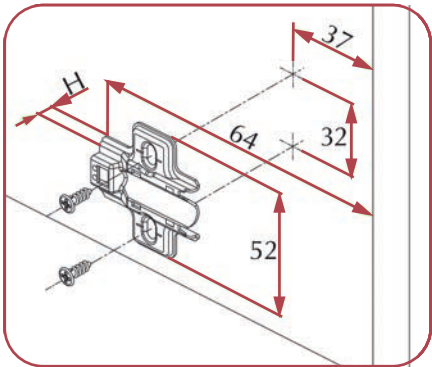
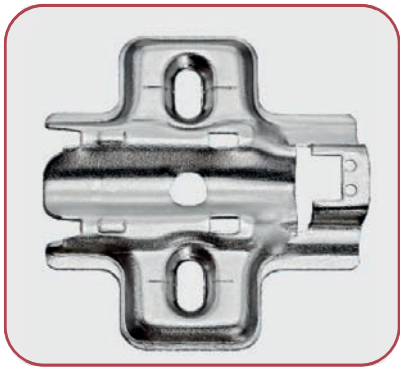

H0 2H0A000WN

H2 2H0A020WN

H4 2H0A040WN

Cruciform plate with pre-assembled euro screws

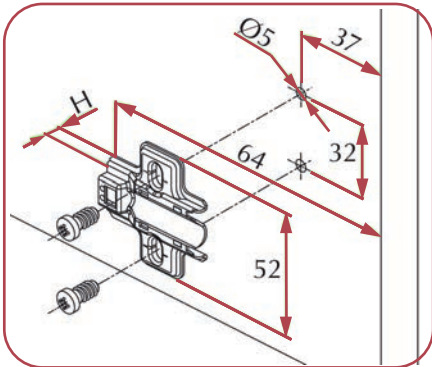
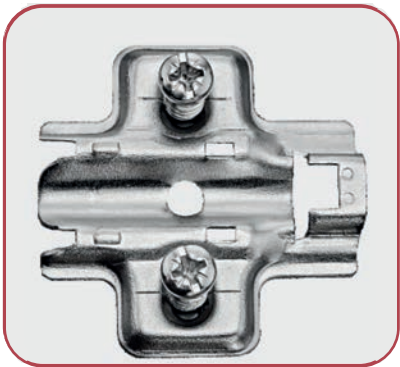

H0 2H0A000EN

H2 2H0A020EN

H4 2H0A040EN

Cruciform plate with pre-assembled 5mm diameter shanks

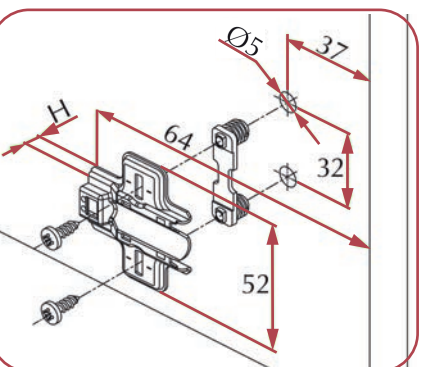
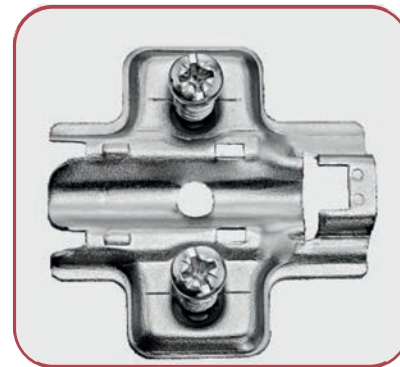

H0 2H0A000DN

H2 2H0A020DN

H4 2H0A040DN

Cruciform plate with pre-assembled 10mm diameter shanks

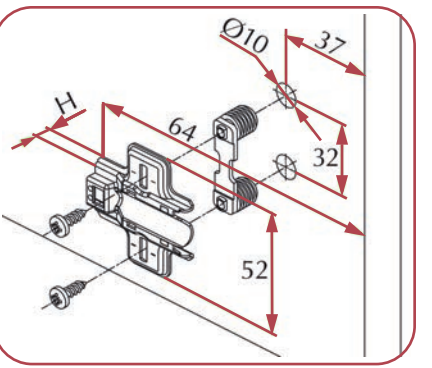
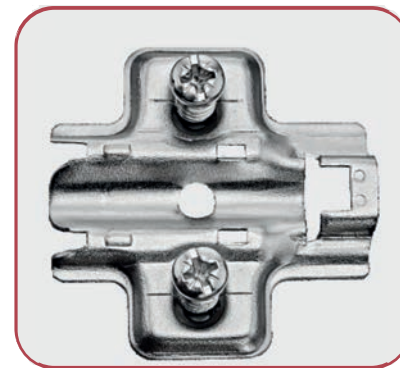

H0 2H0A000FN

H2 2H0A020FN

H4 2H0A040FN

Quattro Cam mounting plates

CAIMIEXPORT

LUXURY HARDWARE

Cruciform plate with cam for wood screws

Heights - codes

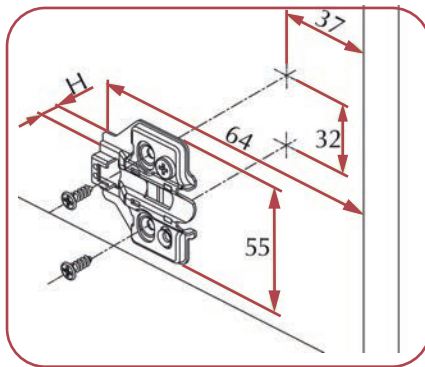
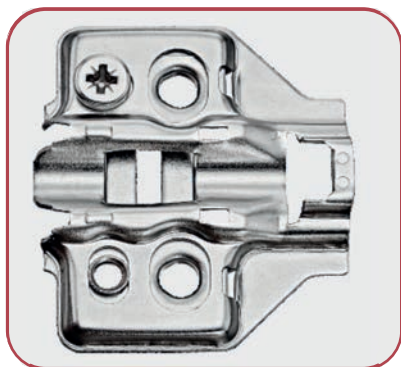

H0 2H0A000WN

H2 2H0A020WN

Cruciform plate with cam and pre-assembled euro screws

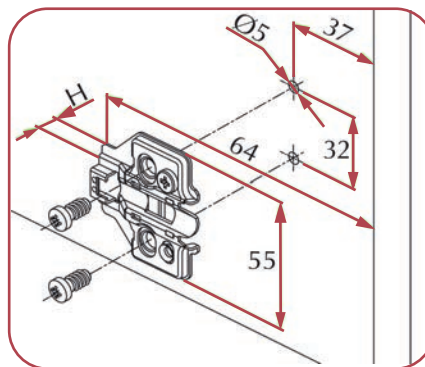
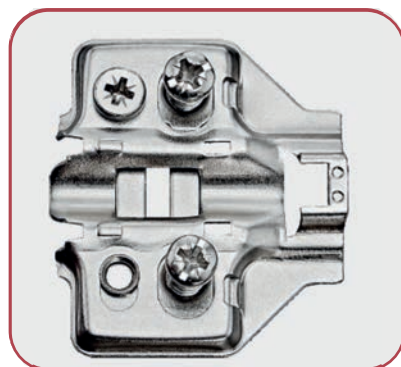

H0 2H0A000EN

H2 2H0A020EN

Cruciform plate with pre-assembled 5mm diameter cam shanks

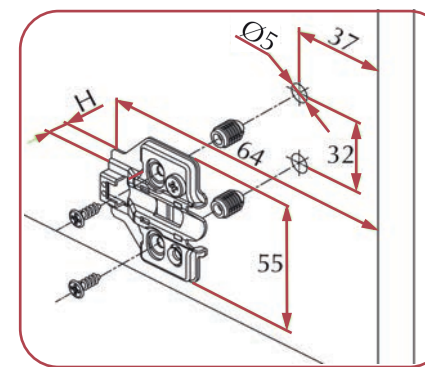
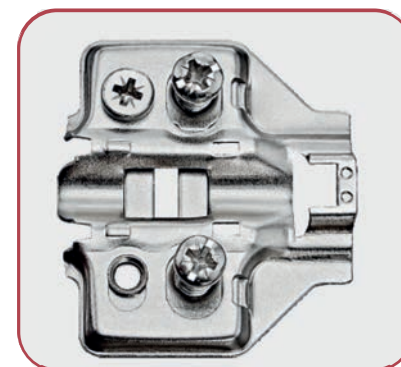

H0 2H0A000DN

H2 2H0A020DN

Cruciform plate with pre-assembled 10mm diameter cam shanks

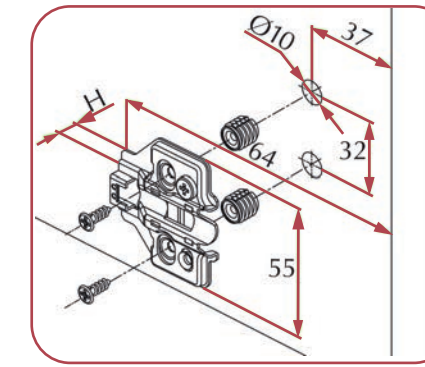
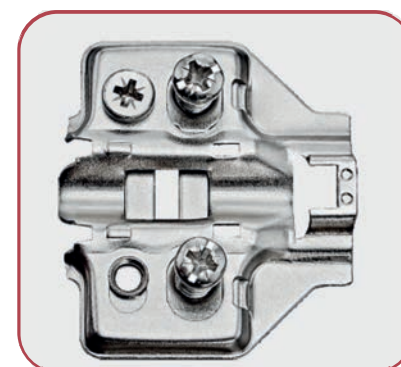

H0 2H0A000FN

H2 2H0A020FN

CAIMIEXPORT

LUXURY HARDWARE

Heights - codes

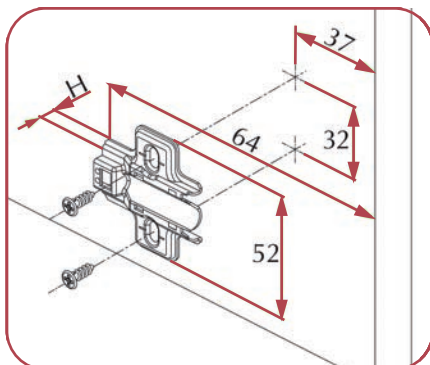

H4 2H0A040WN165

H4 2H0A040EN165

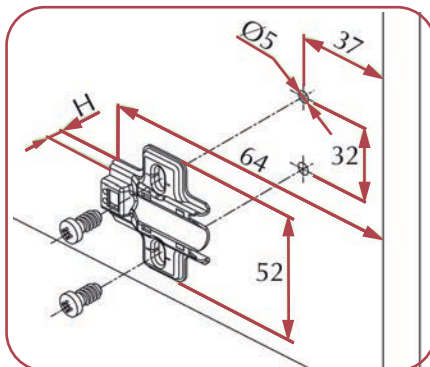

H4 2H0A040DN165

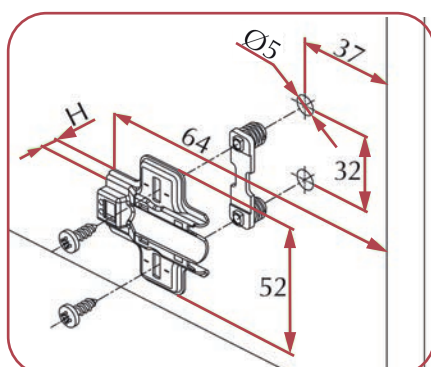

H4 2H0A040FN165

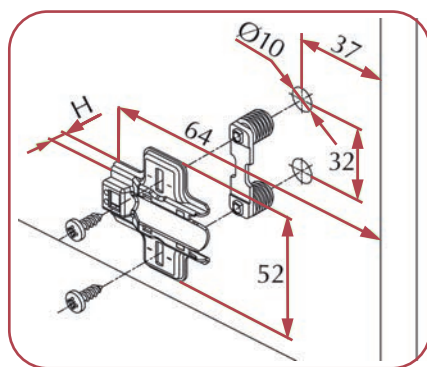

Quattro cam plates for hinges 165°

CAIMIEXPORT
LUXURY HARDWARE

Cruciform plate for wood screws

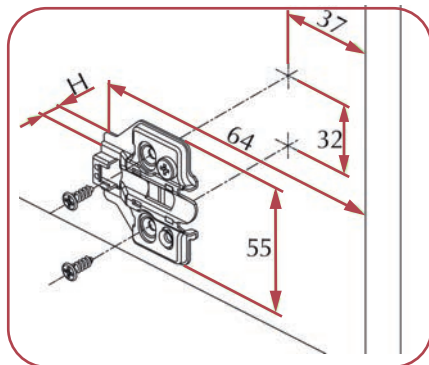
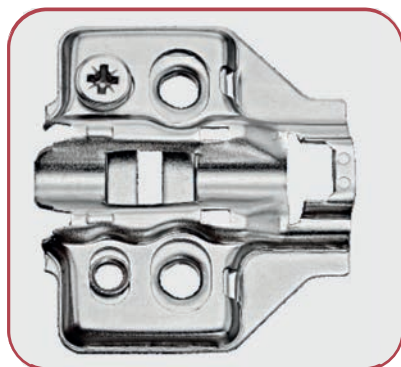

Heights - codes

H0 2H0A000WN165

H2 2H0A020WN165

Cruciform plate with cam and pre-assembled euro screws

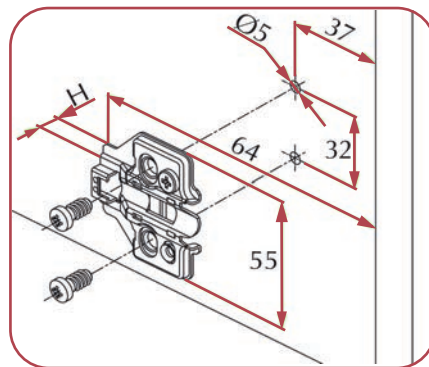
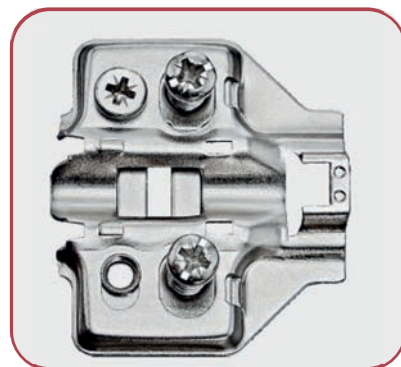

H0 2H0A000EN165

H2 2H0A020EN165

Cruciform plate with pre-assembled 5mm diameter cam shanks

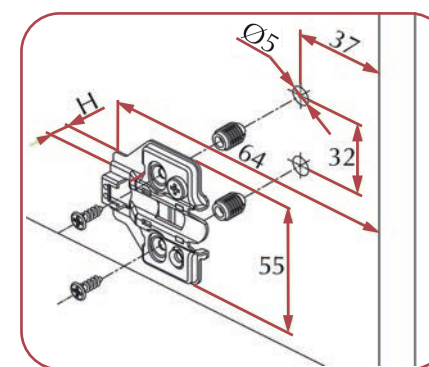
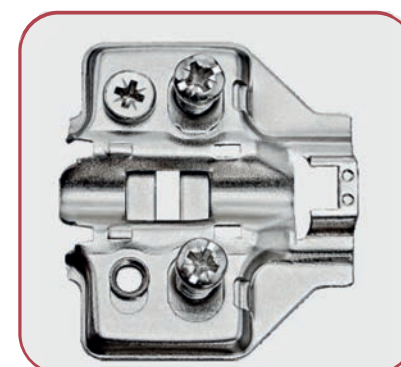

H0 2H0A000DN165

H2 2H0A020DN165

Cruciform plate with pre-assembled 10mm diameter cam shanks

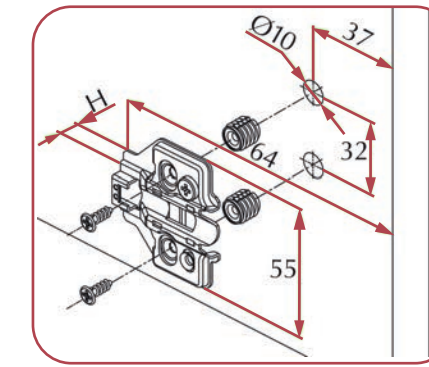
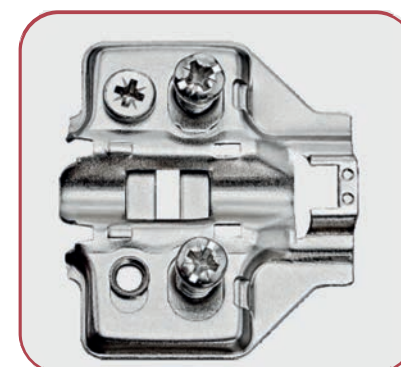

H0 2H0A000FN165

H2 2H0A020FN165



Arm cover

Codes

3H0ABN no logo

3H0ACN Caimi logo

Cup cover

3H0CBN Cup 45-48mm pattern

3H0HBN Cup 52mm pattern

General packaging information

item	pcs./box	box weight kg	box size cm	box/tier	n° tiers	box/pallet	Pallet dim. cm	Pallet weight kg
Hinge crank 0	125	11,44	39*29*12	10	7	70	120*100*104	827,80
Hinge crank 8	125	11,10	39*29*13	10	6	60	120*100*98	693,00
Hinge cranck 15	125	11,47	38*29*14	10	5	50	120*100*90	600,50
Hinge 30°	125	12,28	39*29*15	19	5	50	120*100*95	631,00
Hinge 45°	125	12,08	39*29*15	10	5	50	120*100*95	631,00
Hinge 90°	125	12,37	39*29*15	10	5	50	120*100*95	645,50
Cam bases H0/2	500	13,10	39*29*15	10	7	70	120*100*104	944,0
Cam bases H0/2 pre-assembled euro screws	500	14,30	39*29*15	10	5	50	120*100*95	802,00
Cam bases H0/2 pre-assembled 5mm shanks	500	14,30	39*29*15	10	5	50	120*100*95	742,00
Cam bases H0/2 pre-assembled 8 or 10 shanks	500	14,38	39*29*15	10	5	50	120*100*95	768,50
Bases H0/2/4	500	7,79	39*29*12	10	7	70	120*100*104	572,30
Bases H0/2/4 pre-assembled euro screws	500	11,0	39*29*15	10	5	50	120*100*95	577,00
Bases H0/2/4 pre-assembled 5mm shanks	500	10,25	39*29*15	10	5	50	120*100*95	539,50
Bases H0/2/4 pre-assembled 8 or 10 shanks	500	10,25	39*29*15	10	5	50	120*100*95	539,50
Cup cover	1000	7,25	39*29*15	10	5	50	120*100*95	389,50
Wing cover	5000	12,70	39*29*25	10	3	30	120*100*95	408,00
Hinges 165° crank 0	50	9,45	39*29*12	10	7	70	120*100*104	688,50
Hinges 165° crank 8	50	9,65	39*29*13	10	6	60	120*100*98	606,00
Hinges 165° crank 15	50	9,75	39*29*14	10	5	50	120*100*90	514,50

CAIMIEXPORT

LUXURY HARDWARE



CAIMI Srl
Registered office: Via Villafranca, 4/23
60122 Ancona (AN) – IT
Production site: Via San Primo, 25
Lurago d'Erba (CO) – IT
Administrative headquarters: Via Provinciale, 31
22060 Novedrate (CO) – IT

Cod. Fiscale e P.IVA 08485910965
Cap. Sociale: 15.000,00 int. vers.
R.E.A. Ancona: AN-214329
Phone: +39 031 3510111
Fax: +39 031 3510410
eMail: infocaimi@caimiexport.it
PEC: caimisrl@pec.it