

CAIMIEXPORT

LUXURY HARDWARE

Quattro cerniera clip ammortizzata

AZIENDA

QUALITA' ED ESPERIENZA



La nostra azienda è stata fondata nel 1964.

Nei primi anni della nostra attività ci siamo dedicati alla progettazione e produzione di componenti in alluminio in esclusiva per alcune delle più rinomate aziende nel settore mondo dell'arredamento.

La stretta collaborazione con gli attori importanti del settore e la continua spinta nel trovare soluzioni originali alle esigenze del cliente ci hanno permesso di acquisire competenze distintive in progettazione, sviluppo e industrializzazione di componenti unici.

Oggi siamo in grado di offrire una vasta gamma di prodotti brevettati e progettati per rendere esclusivi armadi guardaroba, soggiorni, cucine, bagni e mobili per ufficio.

Cerchiamo soluzioni per garantire prodotti innovativi ed unici; questo è l'unico modo in cui possiamo migliorare ciò che offriamo ai nostri clienti e proporre sistemi che utilizzano l'alluminio in modo innovativo.

CAIMI Srl

sede legale: Via Villafranca, 4/23
60122 Ancona (AN) – IT

sede produttiva: Via San Primo, 25
Lurago d'Erba (CO) – IT

sede amministrativa: Via Provinciale, 31
22060 Novedrate (CO) – IT

Cod. Fiscale e P.IVA 08485910965

Cap. Sociale: 15.000,00 int. vers.

R.E.A. Ancona: AN-214329

Telefono: +39 031 3510111

Fax: +39 031 3510410

eMail: infocaimi@caimiexport.it

PEC: caimisrl@pec.it

CAIMIEXPORT
LUXURY HARDWARE



CAIMIEXPORT
LUXURY HARDWARE

Quattro Cerniera clip ammortizzata

CAIMIEXPORT
LUXURY HARDWARE

Tecnologia avanzata di chiusura ammortizzata

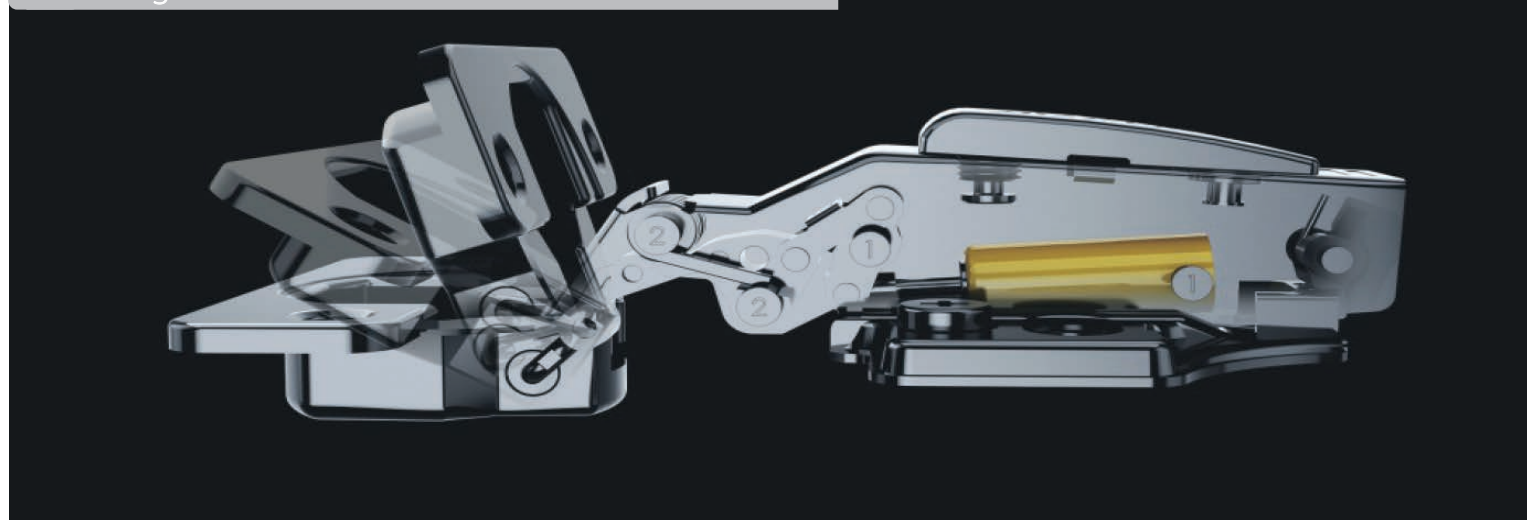

Tecnologia di chiusura ammortizzata progressiva e silenziosa, per preservare l'integrità del mobile nel tempo

Materiali di alta qualità per garantire robustezza, resistenza alla corrosione e stabilità strutturale.

Testato per resistere ai cicli, garantendo una dutabilità e un'affidabilità superiori.

Applicazione versatile: idea per cucine, bagni, camere da letto e mobili su misura, dove la silenziosità e la fluidità del movimento sono requisiti imprescindibili. Un'eleganza che non fa rumore

Regolazione e numero di cerniere consigliate in base al peso e all'altezza della porta



Immagine del prodotto



Descrizione prodotto

- Diametro della tazza: 35 mm
- Profondità tazza: 11 mm
- Max. Angolo apertura: 105 °
- Distanza foratura della porta (k): 3-7 mm
- Spessore porta (t): 16-26 mm
- Regolazione della profondità con Cochlea
- Programma completo di tipologie di fissaggio
- Distanza foro tazza: 45-48-52mm
- Struttura robusta per alte prestazioni
- Apertura a 2 vie per evitare danni all'anta
- Cerniera disponibile senza ammortizzatore

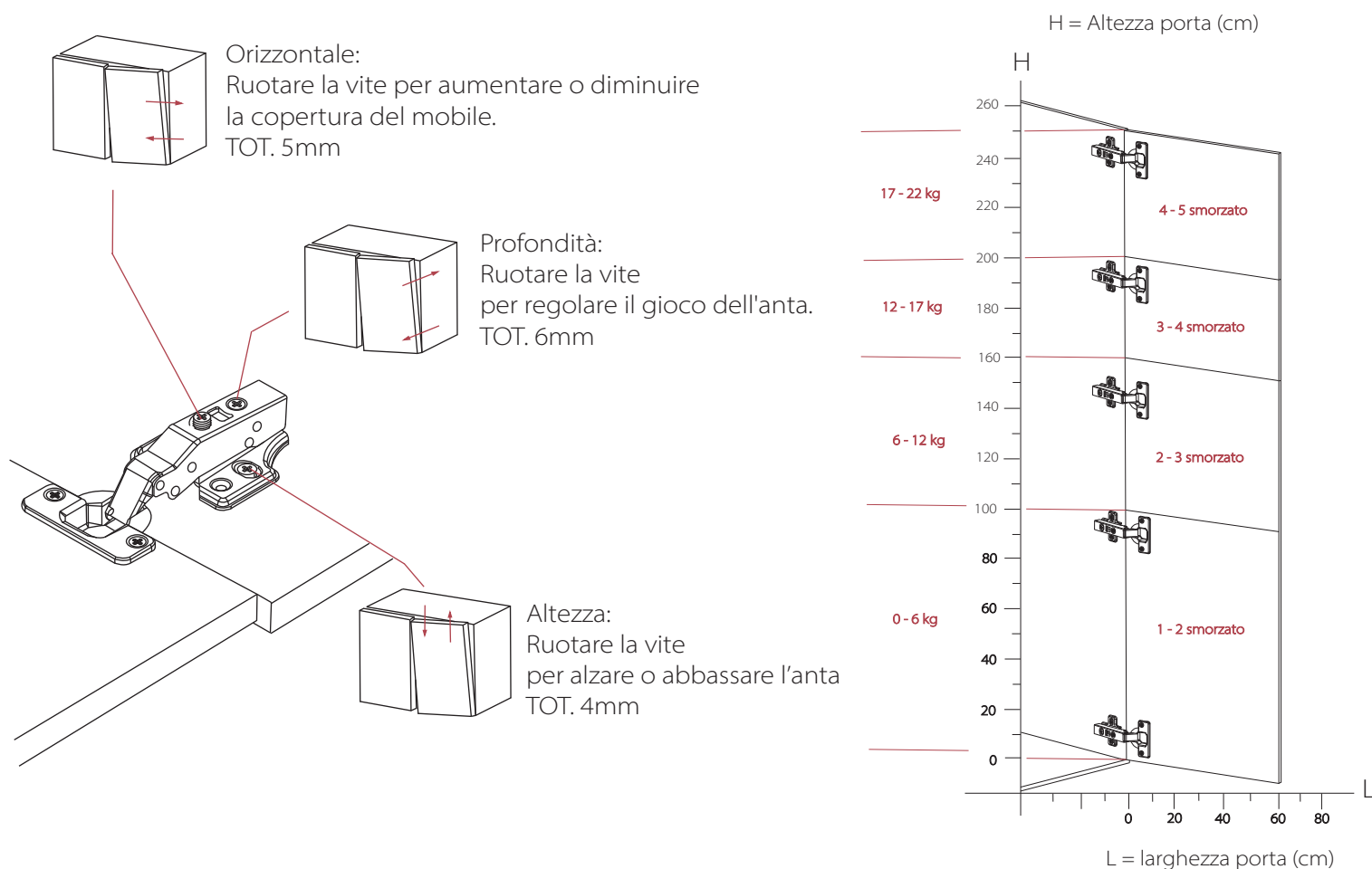
Foratura per tazza

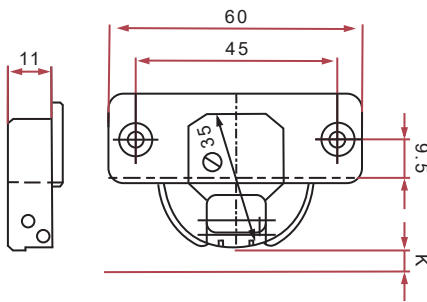

B-45

Copertura totale

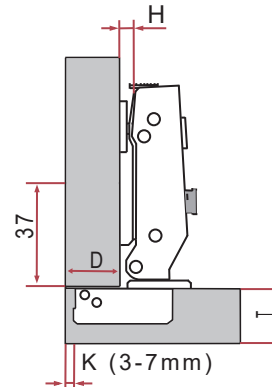

$$H=14+K-D$$

$\begin{matrix} D \\ H \end{matrix} K$	3	4	5	6	7
0	17	18	19	20	21
2	15	16	17	18	19

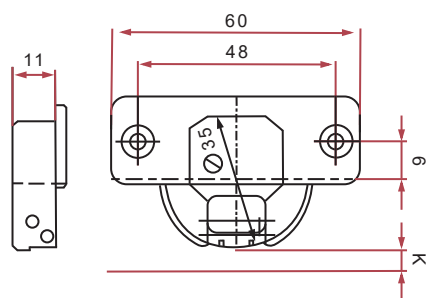

S-48

Copertura parziale

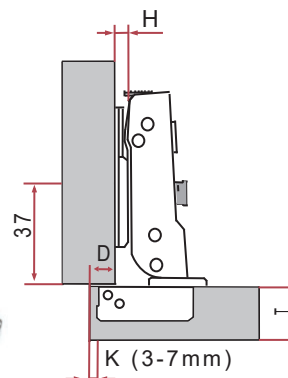

$$H=4+K-D$$

$\begin{matrix} D \\ H \end{matrix} K$	3	4	5	6	7
0	7	8	9	10	11
2	5	6	7	8	9

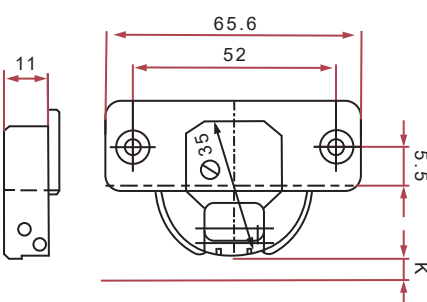

H-52

Anta interna

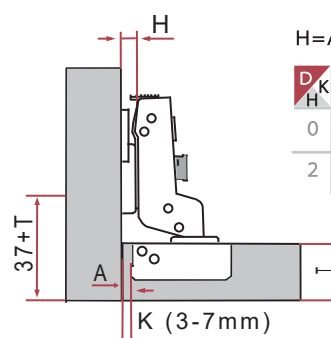

$$H=A+K-5$$

$\begin{matrix} D \\ H \end{matrix} K$	3	4	5	6	7
0	2	1	0	-1	-2
2	4	3	2	1	0

Quattro Cerniera clip ammortizzata

Fissaggio Tazza

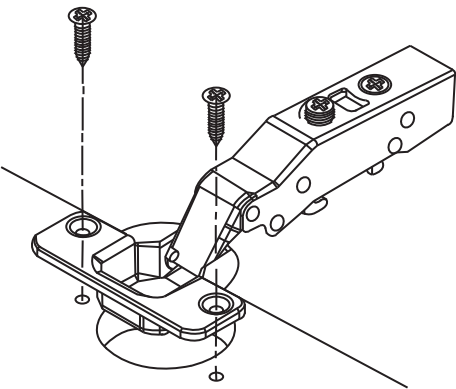

Avvitare

- W

Vite legno 4X16
- W

Vite Euro

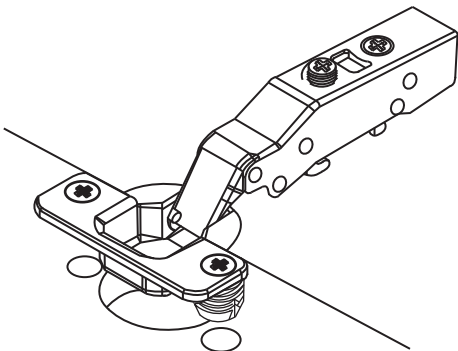

Premere

- C

Tassello M8
- D

Tassello M10

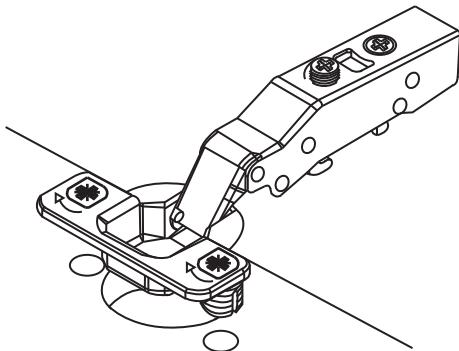

Espandere

- C

Tassello M10 a espansione

Tabella minima di rivelazione

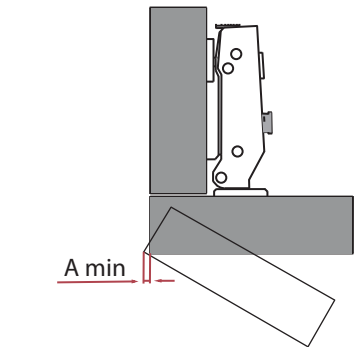

<div>A</div> <div>K</div> <div>T</div>	16	17	18	19	20	21	22	23	24	25	26
3	0.9	1.1	1.5	1.8	2.3	2.8	3.6	4.3	5.2	6.0	6.9
4	0.8	1.1	1.4	1.8	2.2	2.7	3.3	4.0	4.7	5.5	6.5
5	0.8	1.0	1.3	1.7	2.1	2.5	3.1	3.7	4.4	5.1	5.9
6	0.8	1.0	1.3	1.6	1.9	2.3	2.7	3.3	3.8	4.5	5.2
7	0.7	1.0	1.3	1.6	1.9	2.3	2.7	3.3	3.8	4.5	5.2

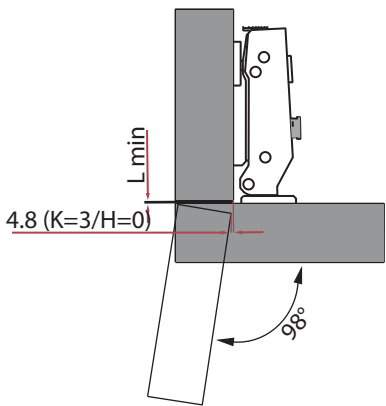

<div>L</div> <div>K</div> <div>T</div>	16	17	18	19	20	21	22	23	24	25	26
3	0.0	0.0	0.0	0.0	0.0	0.0	0.0	0.0	0.0	0.0	0.0
4	0.0	0.0	0.0	0.0	0.0	0.0	0.0	0.0	0.0	0.0	0.0
5	0.0	0.0	0.0	0.1	0.2	0.3	0.4	0.6	0.7	0.9	1.0
6	0.6	0.8	1.0	1.1	1.2	1.3	1.4	1.6	1.8	1.9	2.0
7	1.6	1.8	2.0	2.1	2.2	2.3	2.4	2.6	2.8	2.9	3.0

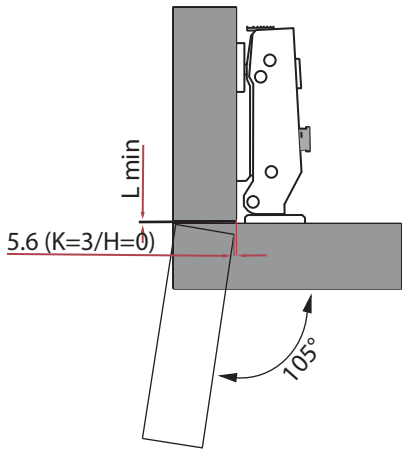

<div>L</div> <div>K</div> <div>T</div>	16	17	18	19	20	21	22	23	24	25	26
3	0.0	0.0	0.0	0.0	0.2	0.5	0.7	1.0	1.4	1.5	1.8
4	0.1	0.4	0.6	0.9	1.2	1.5	1.7	2.0	2.2	2.5	2.7
5	1.1	1.4	1.6	1.9	2.2	2.4	2.7	2.9	3.2	3.5	3.7
6	2.1	2.3	2.6	2.9	3.1	3.4	3.6	3.9	4.2	4.4	4.7
7	3.1	3.3	3.6	3.8	4.1	4.3	4.6	4.9	5.1	5.4	6.5

Quattro Cerniera clip ammortizzata

CAIMIEXPORT

LUXURY HARDWARE

Codice articolo

▲ Copertura totale



▲ Copertura parziale



▲ Anta interna

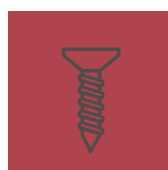

B 1H000B0AWN
S 1H000S0AWN
H 1H000H0AWN

1H008B0AWN
1H008S0AWN
1H008H0AWN

1H015B0AWN
1H015S0AWN
1H015H0AWN

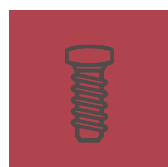

B 1H000B0AEN
S 1H000S0AEN
H 1H000H0AEN

1H008B0AEN
1H008S0AEN
1H008H0AEN

1H015B0AEN
1H015S0AEN
1H015H0AEN

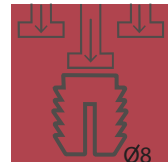

B 1H000B0ACN
S 1H000S0ACN
H 1H000H0ACN

1H008B0ACN
1H008S0ACN
1H008H0ACN

1H015B0ACN
1H015S0ACN
1H015H0ACN

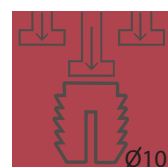

B 1H000B0ADN
S 1H000S0ADN
H 1H000H0ADN

1H008B0ADN
1H008S0ADN
1H008H0ADN

1H015B0ADN
1H015S0ADN
1H015H0ADN

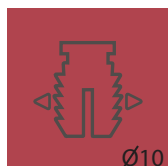

B 1H000B0AXN
S 1H000S0AXN
H 1H000H0AXN

1H008B0AXN
1H008S0AXN
1H008H0AXN

1H015B0AXN
1H015S0AXN
1H015H0AXN

Foratura per tazza

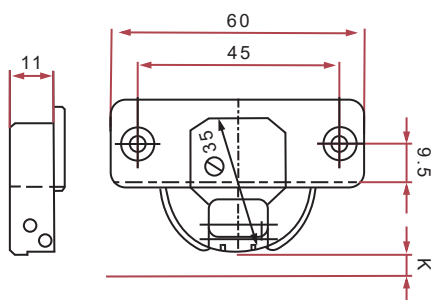

B-45

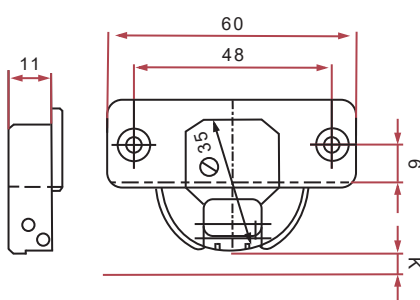

S-48

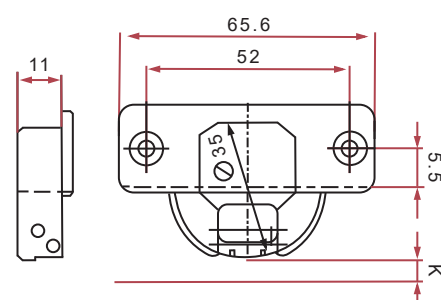

H-52

Quattro Cerniera clip ammortizzata (colli inclinati)

CAIMIEXPORT

LUXURY HARDWARE

Immagine del prodotto



Descrizione prodotto

- Cerniera colli inclinati, 30°-45°-90°
- Diametro della tazza: 35 mm
- Profondità tazza: 11 mm
- Max. Angolo apertura: 105 °
- Distanza foratura della porta (k): 3-7 mm
- Spessore porta (t): 16-26 mm
- Programma completo di tipologie di fissaggio
- Distanza foro tazza: 45-48-52mm
- Struttura robusta per alte prestazioni
- Apertura a 2 vie per evitare danni all'anta
- Cerniera disponibile senza ammortizzatore

Foratura per tazza

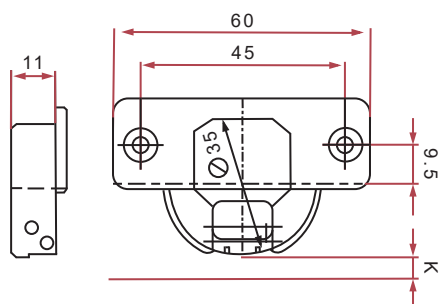

B-45

▲ 30°

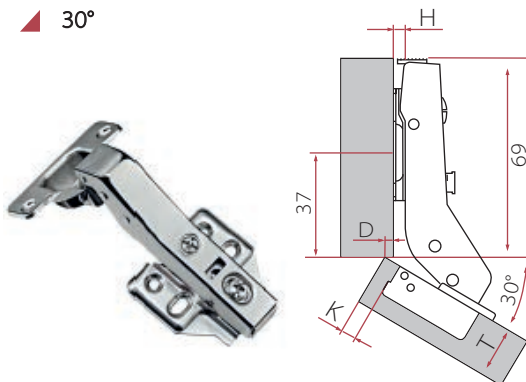

30°

D H K	3	4	5	6	7
0	0.3	1.1	2	2.9	3.7
2	-1,7	-0.9	0	0.9	1.7

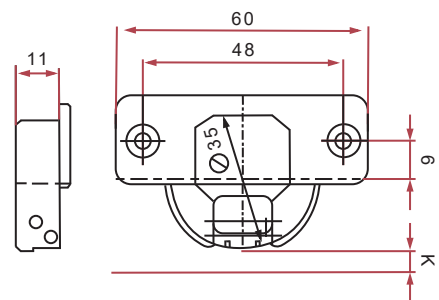

S-48

▲ 45°

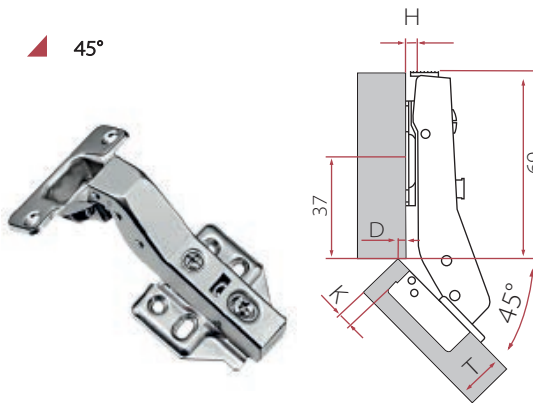

45°

D H K	3	4	5	6	7
0	0.6	1.3	2	2.7	3.4
2	-1.4	-0.7	0	0.7	1.4

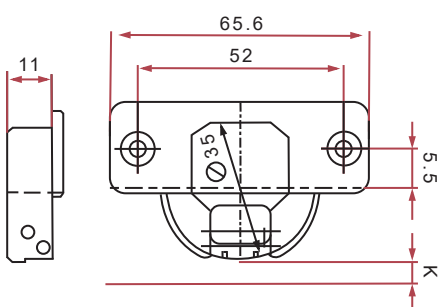

H-52

▲ 90°

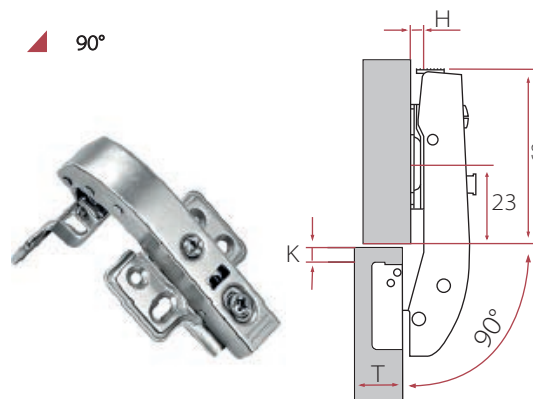

90°

D H K	4	5	6		
0	2	2	2		
2	0	0	0		

Quattro Cerniera clip ammortizzata (colli inclinati)

CAIMIEXPORT

LUXURY HARDWARE

Fissaggio Tazza

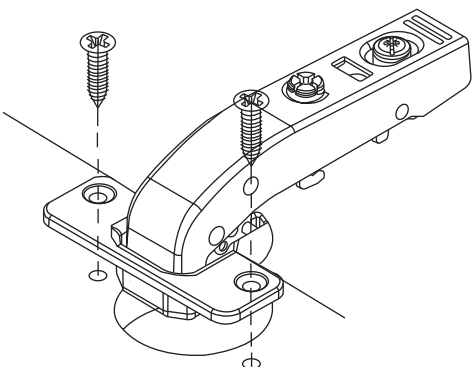

Avvitare

W Vite legno 4X16

W Vite Euro

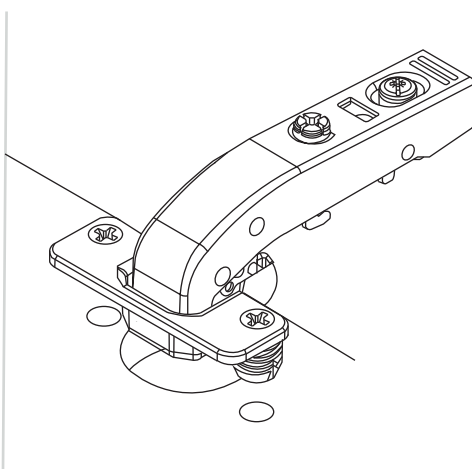

Premere

C Tassello M8

D Tassello M10

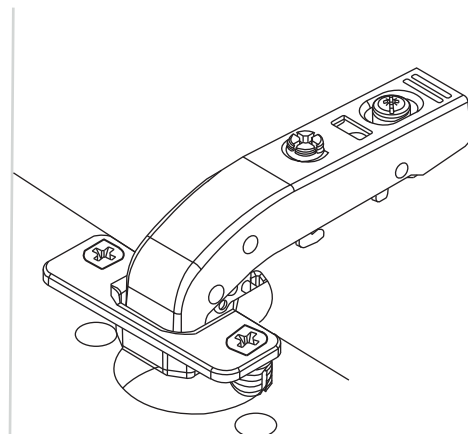

Espandere

C Tassello M10 a espansione

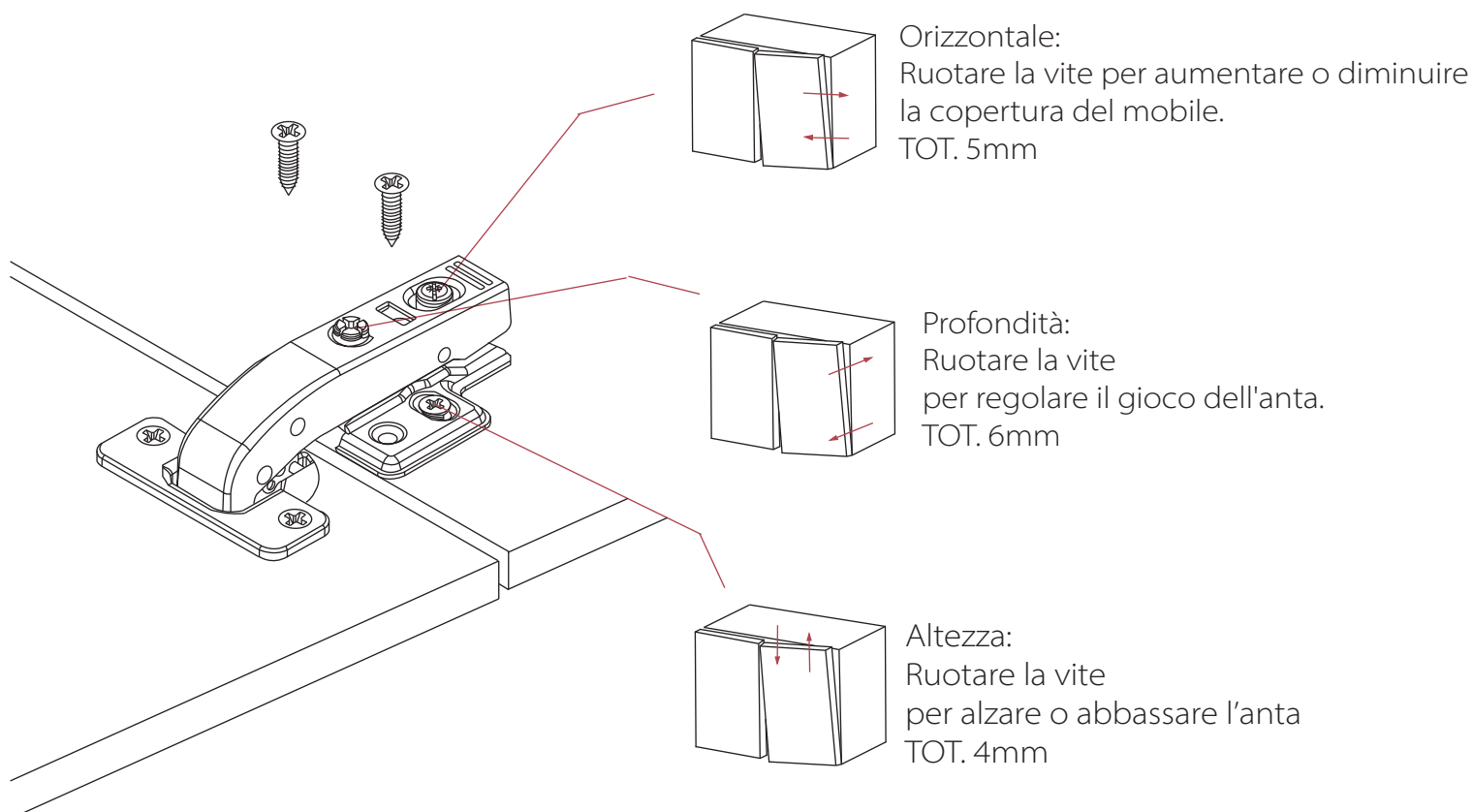

Codice articolo

30°



45°



90°



B1H030B0AWN

S1H030S0AWN

H1H030H0AWN

1H045B0AWN

1H045S0AWN

1H045H0AWN

1H090B0AWN

1H090S0AWN

1H090H0AWN

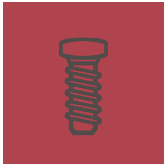

B1H030B0AEN

S1H030S0AEN

H1H030H0AEN

1H045B0AEN

1H045S0AEN

1H045H0AEN

1H090B0AEN

1H090S0AEN

1H090H0AEN

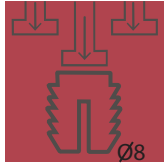

B1H030B0ACN

S1H030S0ACN

H1H030H0ACN

1H045B0ACN

1H045S0ACN

1H045H0ACN

1H090B0ACN

1H090S0ACN

1H090H0ACN

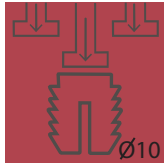

B1H030B0ADN

S1H030S0ADN

H1H030H0ADN

1H045B0ADN

1H045S0ADN

1H045H0ADN

1H090B0ADN

1H090S0ADN

1H090H0ADN

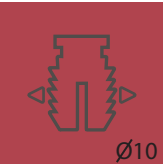

B1H030B0AXN

S1H030S0AXN

H1H030H0AXN

1H045B0AXN

1H045S0AXN

1H045H0AXN

1H090B0AXN

1H090S0AXN

1H090H0AXN

Foratura per tazza

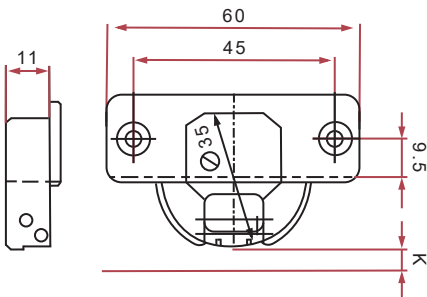

B-45

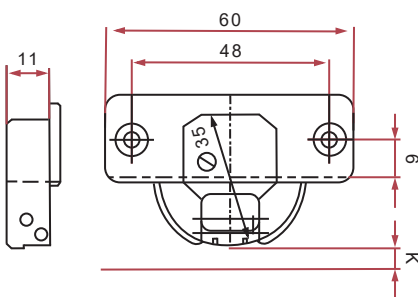

S-48

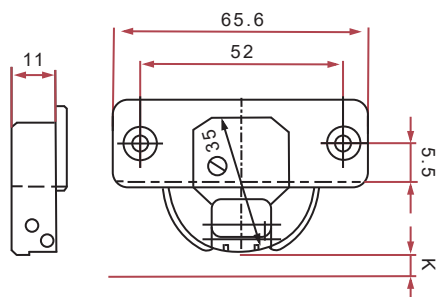

H-52

Quattro Cerniere clip ammortizzate 165°

CAIMIEXPORT
LUXURY HARDWARE

Immagine del prodotto



Descrizione prodotto

- Cerniera per apertura speciale 165°
- Diametro della tazza: 35 mm
- Profondità tazza: 11,4 mm
- Max. Angolo apertura: 165 °
- Distanza foratura della porta (k): 3-7 mm
- Spessore porta (t): 16-26 mm
- Programma completo di tipologie di fissaggio
- Distanza foro tazza: 45-48-52mm
- Struttura robusta per alte prestazioni
- Apertura a 2 vie per evitare danni all'anta
- Cerniera disponibile senza ammortizzatore

Foratura per tazza

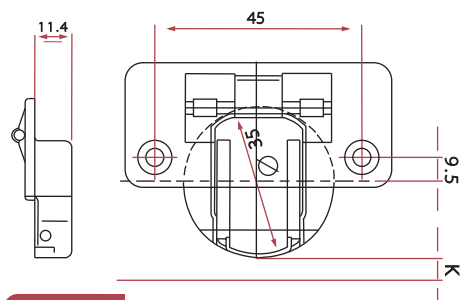

B-45

▲ Copertura totale

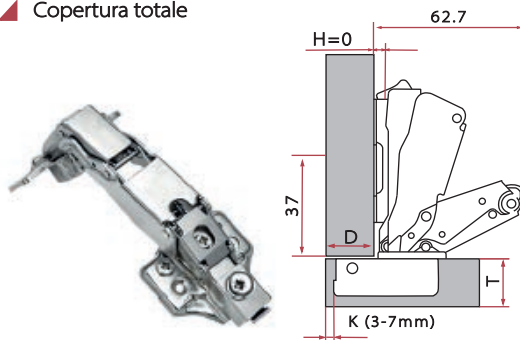

$H=14+K-D$

$\begin{smallmatrix} D \\ H \end{smallmatrix}$ K	3	4	5	6	7
0	17	18	19	20	21
2	15	16	17	18	19

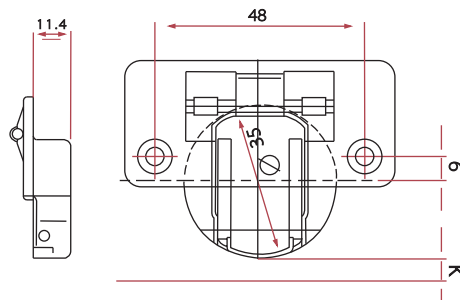

S-48

▲ Copertura parziale

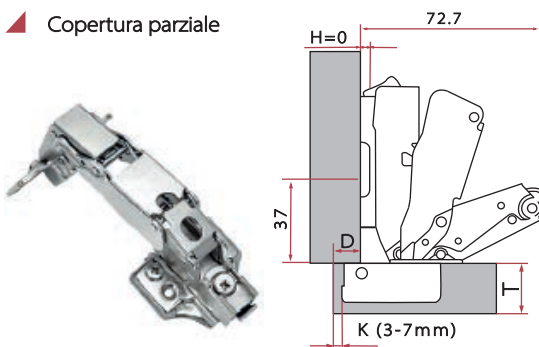

$H=4+K-D$

$\begin{smallmatrix} D \\ H \end{smallmatrix}$ K	3	4	5	6	7
0	7	8	9	10	11
2	5	6	7	8	9

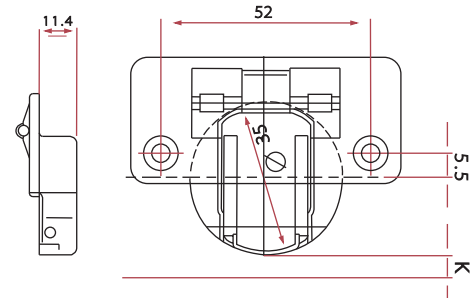

H-52

▲ Anta interna

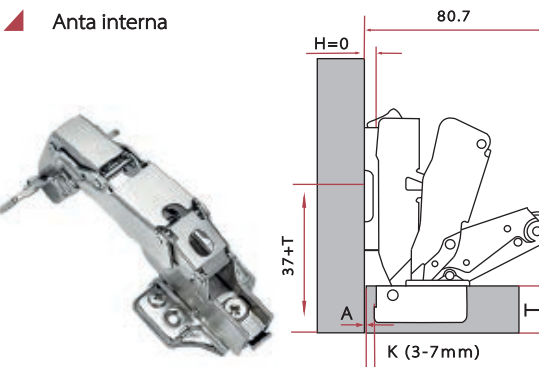

$H=A+K-4$

$\begin{smallmatrix} D \\ H \end{smallmatrix}$ K	3	4	5	6	7
0	1	0	-1	-2	-3
2	3	2	1	0	-1

Quattro Cerniere clip ammortizzate 165°

CAIMIEXPORT
LUXURY HARDWARE

Fissaggio Tazza

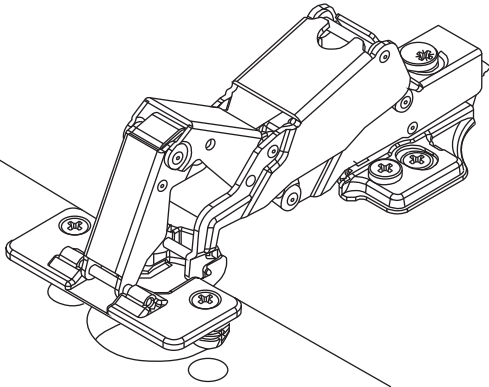
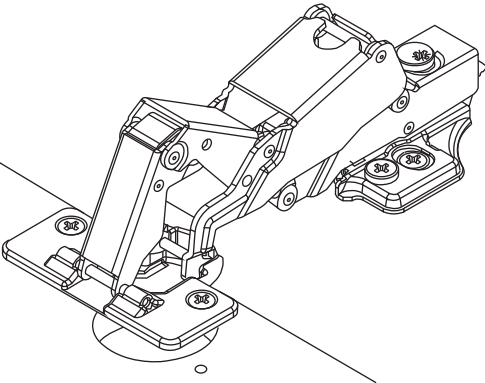

Avvitare

- W** Vite legno 4X16
- W** Vite Euro

Premere

- C** Tassello M8
- D** Tassello M10

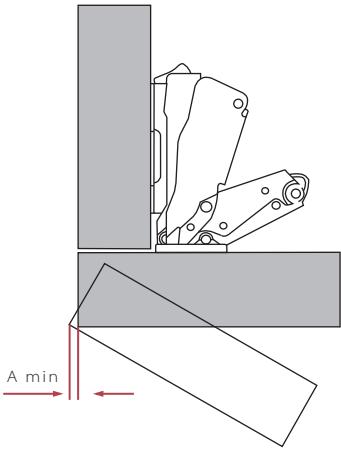

A K T	16	17	18	19	20	21	22	23	24	25	26
3	0.0	0.0	0.10	0.23	0.47	0.61	0.90	2.95	3.65	4.72	5.64
4	0.0	0.0	0.07	0.18	0.37	0.53	0.90	1.85	3.08	3.92	4.85
5	0.0	0.0	0.0	0.13	0.29	0.58	1.07	1.73	2.48	3.30	4.16
6	0.0	0.0	0.0	0.10	0.22	0.46	0.85	1.39	2.05	2.79	3.58
7	0.0	0.0	0.0	0.07	0.19	0.38	0.69	1.14	1.71	2.39	3.10

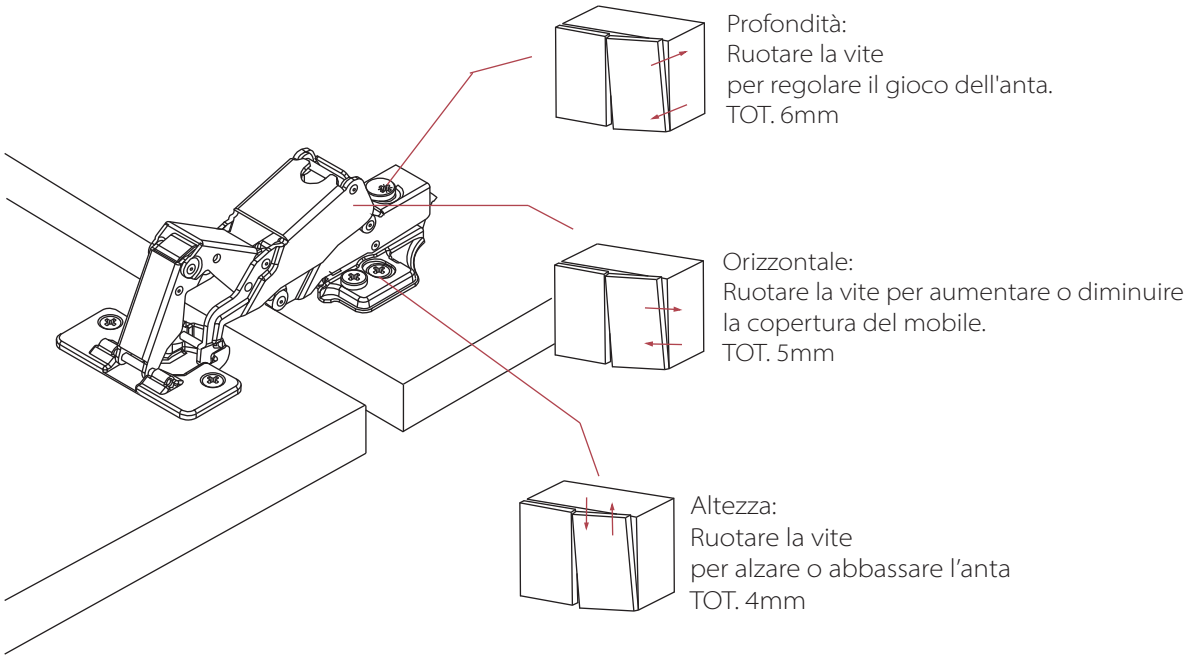

Quattro Cerniere clip ammortizzate 165°

CAIMIEXPORT

LUXURY HARDWARE

Codice articolo

▲ Copertura totale



▲ Copertura parziale



▲ Anta interna



B 1H000B0BWN
S 1H000S0BWN
H 1H000H0BWN

1H008B0BWN
1H008S0BWN
1H008H0BWN

1H015B0BWN
1H015S0BWN
1H015H0BWN

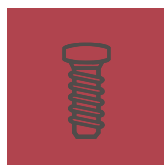

B 1H000B0BEN
S 1H000S0BEN
H 1H000H0BEN

1H008B0BEN
1H008S0BEN
1H008H0BEN

1H015B0BEN
1H015S0BEN
1H015H0BEN

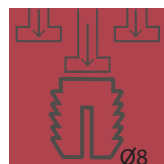

B 1H000B0BCN
S 1H000S0BCN
H 1H000H0BCN

1H008B0BCN
1H008S0BCN
1H008H0BCN

1H015B0BCN
1H015S0BCN
1H015H0BCN

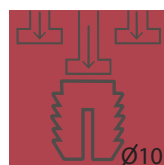

B 1H000B0BDN
S 1H000S0BDN
H 1H000H0BDN

1H008B0BDN
1H008S0BDN
1H008H0BDN

1H015B0BDN
1H015S0BDN
1H015H0BDN

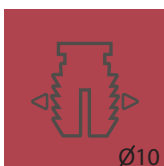

B 1H000B0BXN
S 1H000S0BXN
H 1H000H0BXN

1H008B0BXN
1H008S0BXN
1H008H0BXN

1H015B0BXN
1H015S0BXN
1H015H0BXN

Foratura per tazza

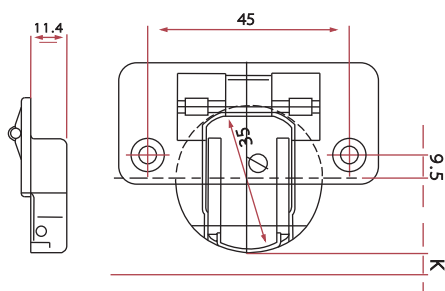

B-45

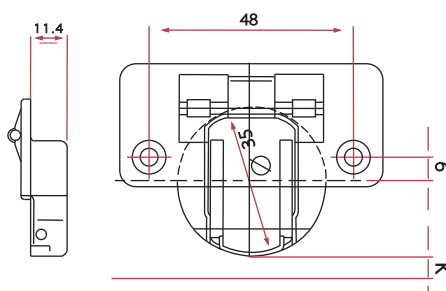

S-48

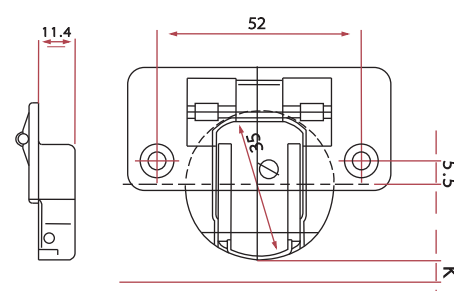

H-52

Quattro Basi standard

CAIMIEXPORT

LUXURY HARDWARE

Base cruciforme per viti legno

Altezze - codici

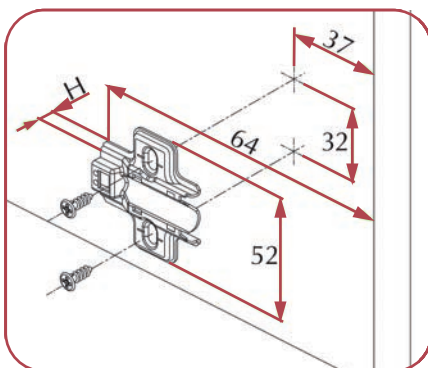
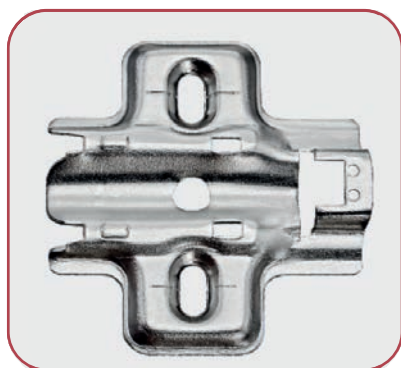

H0 2H0A000WN

H2 2H0A020WN

H4 2H0A040WN

Base cruciforme con viti euro premontate

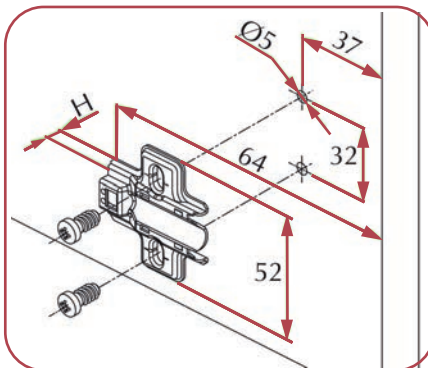
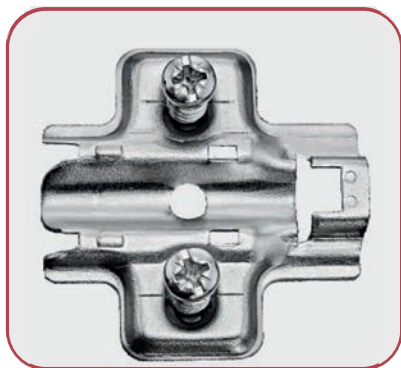

H0 2H0A000EN

H2 2H0A020EN

H4 2H0A040EN

Base cruciforme con codoli diametro 5 pre montati

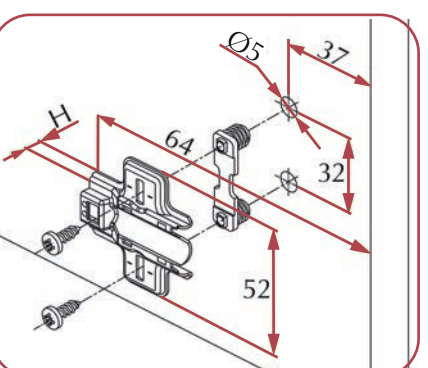
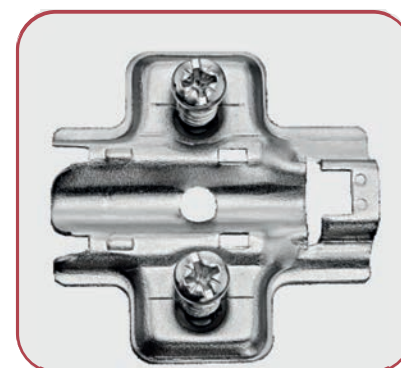

H0 2H0A000DN

H2 2H0A020DN

H4 2H0A040DN

Base cruciforme con codoli diametro 10 pre montati

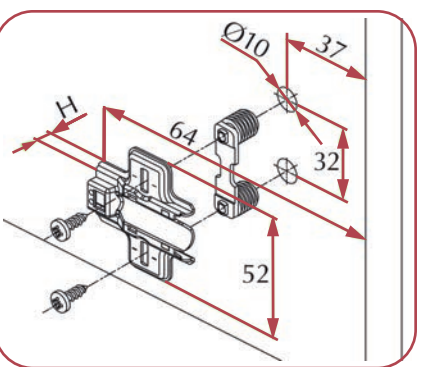
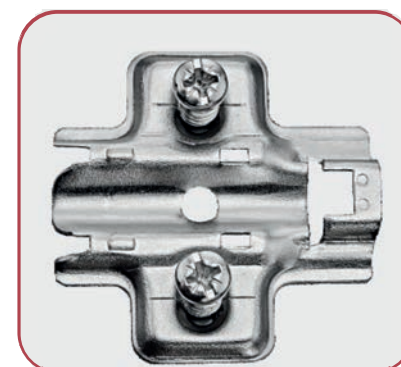

H0 2H0A000FN

H2 2H0A020FN

H4 2H0A040FN

Quattro Basi con camma

CAIMIEXPORT

LUXURY HARDWARE

Base cruciforme con camma per viti legno

Altezze - codici

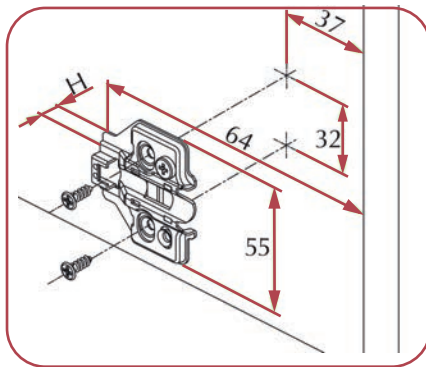
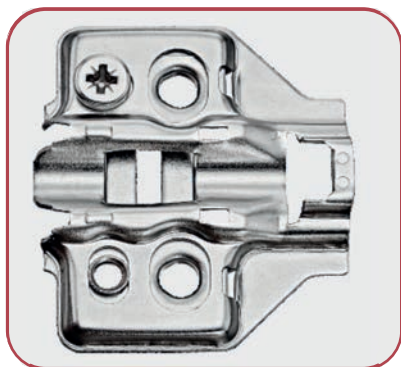

H0 2H0A000WN

H2 2H0A020WN

Base cruciforme con camma viti euro premontate

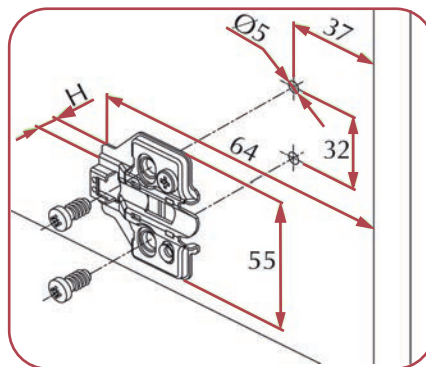
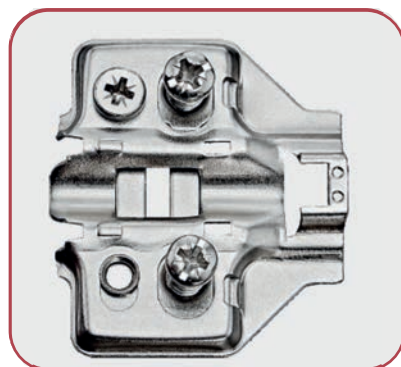

H0 2H0A000EN

H2 2H0A020EN

Base cruciforme con camma codoli diametro 5 pre montati

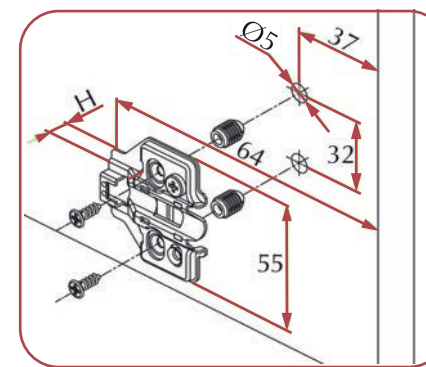
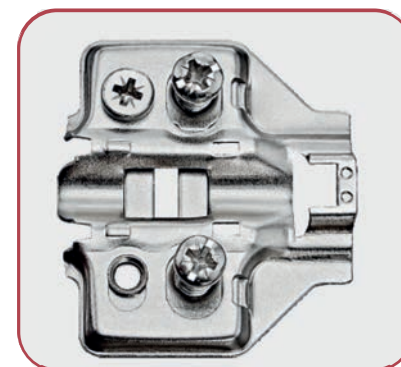

H0 2H0A000DN

H2 2H0A020DN

Base cruciforme con camma codoli diametro 10 pre montati

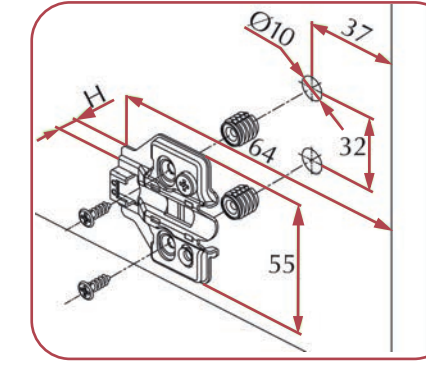
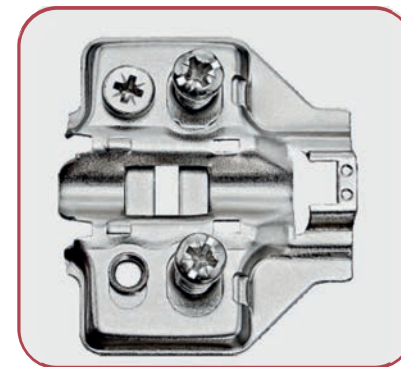

H0 2H0A000FN

H2 2H0A020FN

Quattro Basi standard per cerniera 165°

CAIMIEXPORT
LUXURY HARDWARE

Base cruciforme per viti legno

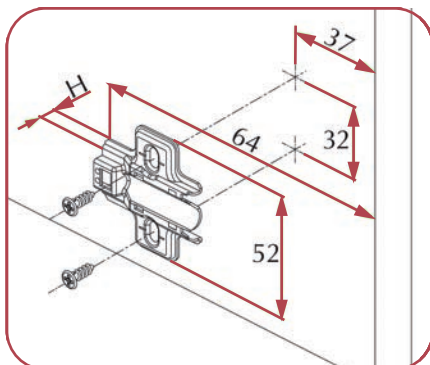

Altezze - codici

H0 2H0A000WN165

H2 2H0A020WN165

H4 2H0A040WN165

Base cruciforme con viti euro premontate

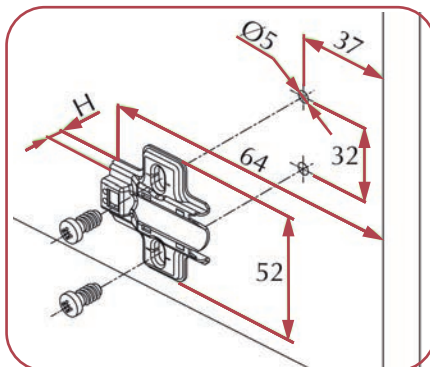
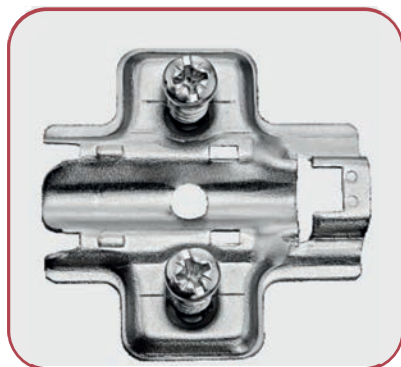

H0 2H0A000EN165

H2 2H0A020EN165

H4 2H0A040EN165

Base cruciforme con codoli diametro 5 pre montati

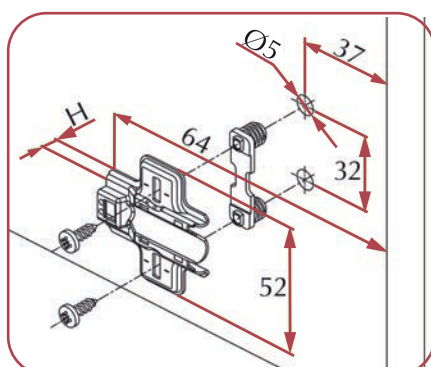
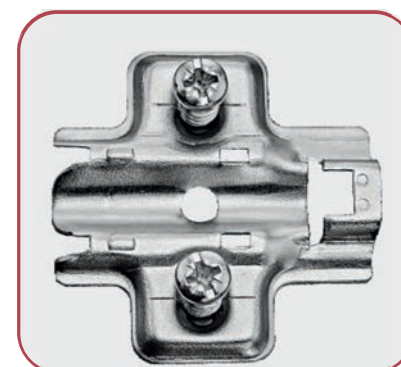

H0 2H0A000DN165

H2 2H0A020DN165

H4 2H0A040DN165

Base cruciforme con codoli diametro 10 pre montati

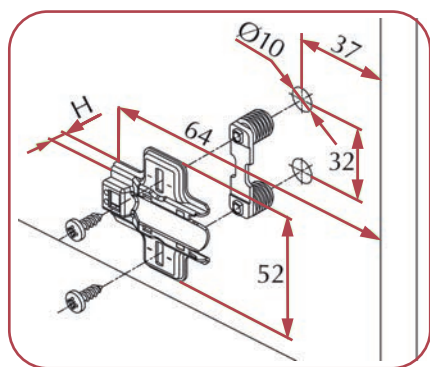
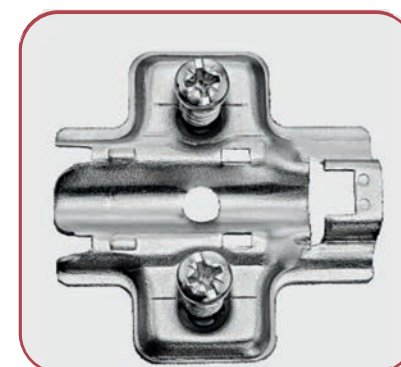

H0 2H0A000FN165

H2 2H0A020FN165

H4 2H0A040FN165

Quattro Basi con camma per cerniera 165°

CAIMIEXPORT**LUXURY HARDWARE**

Base cruciforme con camma per viti legno

Altezze - codici

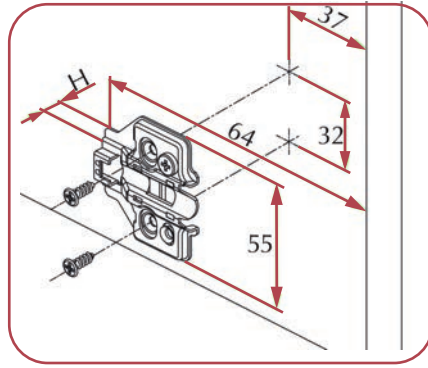
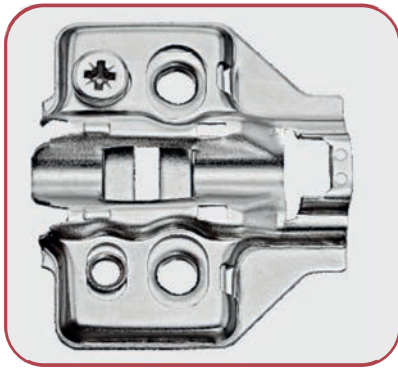

H0 2H0A000WN165

H2 2H0A020WN165

Base cruciforme con camma viti euro premontate

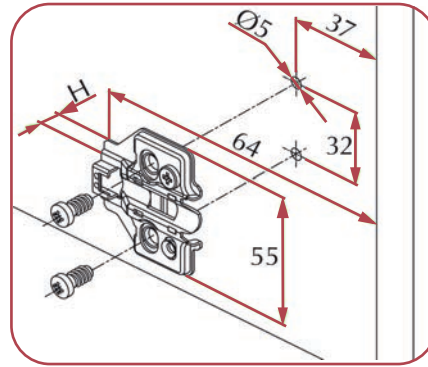
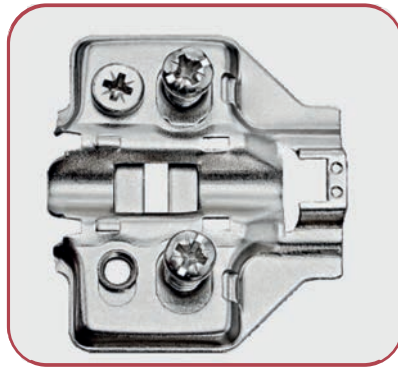

H0 2H0A000EN165

H2 2H0A020EN165

Base cruciforme con camma codoli diametro 5 pre montati

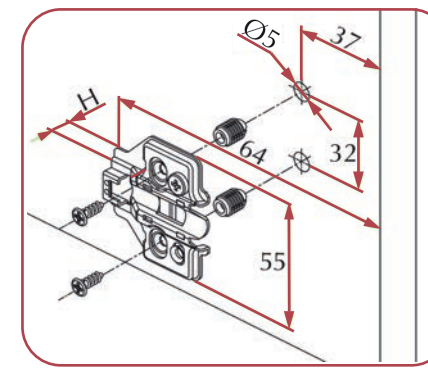
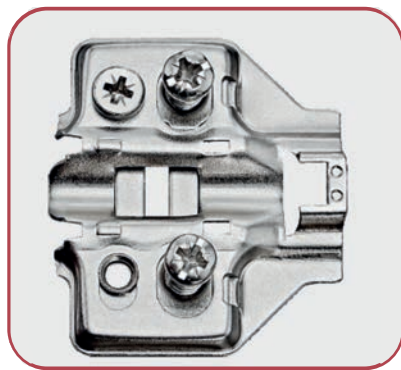

H0 2H0A000DN165

H2 2H0A020DN165

Base cruciforme con camma codoli diametro 10 pre montati

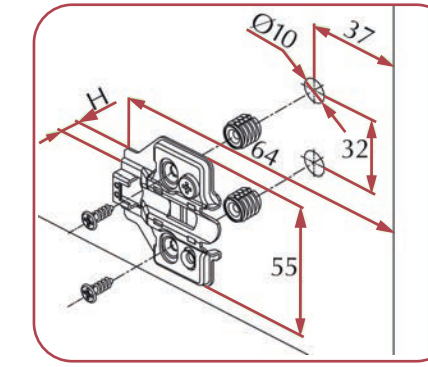
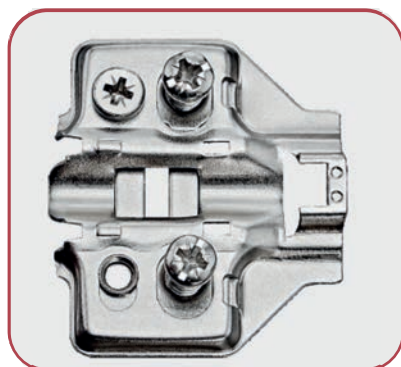

H0 2H0A000FN165

H2 2H0A020FN165



Copri ala



Codici

3H0ABN no logo

3H0ACN Caimi logo

Copri tazza



3H0CBN tazza int. 45-48mm

3H0HBN tazza int. 52mm

Informazioni generali d'imballo

articolo	pcs./scat.	peso scat. kg	dim.scatola cm	scat./piano	n° piani	scat./pallet	dim.pallet cm	peso pallet kg
Cerniera collo 0	125	11,44	39*29*12	10	7	70	120*100*104	827,80
Cerniera collo 8	125	11,10	39*29*13	10	6	60	120*100*98	693,00
Cerniera collo 15	125	11,47	38*29*14	10	5	50	120*100*90	600,50
Cerniera 30°	125	12,28	39*29*15	19	5	50	120*100*95	631,00
Cerniera 45°	125	12,08	39*29*15	10	5	50	120*100*95	631,00
Cerniera 90°	125	12,37	39*29*15	10	5	50	120*100*95	645,50
Base con camma H0/2	500	13,10	39*29*15	10	7	70	120*100*104	944,0
Base con camma H0/2 euroviti premontate	500	14,30	39*29*15	10	5	50	120*100*95	802,00
Base con camma H0/2 codoli 5mm premontati	500	14,30	39*29*15	10	5	50	120*100*95	742,00
Base con camma H0/2 con codoli 8 o 10 premontati	500	14,38	39*29*15	10	5	50	120*100*95	768,50
Base H0/2/4	500	7,79	39*29*12	10	7	70	120*100*104	572,30
Base H0/2/4 euroviti premontati	500	11,0	39*29*15	10	5	50	120*100*95	577,00
Base H0/2/4 codoli 5mm premontati	500	10,25	39*29*15	10	5	50	120*100*95	539,50
Base H0/2/4 codoli 8 e 10mm premontati	500	10,25	39*29*15	10	5	50	120*100*95	539,50
Copri tazza	1000	7,25	39*29*15	10	5	50	120*100*95	389,50
Copri ala	5000	12,70	39*29*25	10	3	30	120*100*95	408,00
Cerniera 165° collo 0	50	9,45	39*29*12	10	7	70	120*100*104	688,50
Cerniera 165° collo 8	50	9,65	39*29*13	10	6	60	120*100*98	606,00
Cerniera 165° collo 15	50	9,75	39*29*14	10	5	50	120*100*90	514,50

CAIMIEXPORT

LUXURY HARDWARE



CAIMI Srl
sede legale: Via Villafranca, 4/23
60122 Ancona (AN) – IT
sede produttiva: Via San Primo, 25
Lurago d'Erba (CO) – IT
sede amministrativa: Via Provinciale, 31
22060 Novedrate (CO) – IT

Cod. Fiscale e P.IVA 08485910965
Cap. Sociale: 15.000,00 int. vers.
R.E.A. Ancona: AN-214329
Telefono: +39 031 3510111
Fax: +39 031 3510410
eMail: infocaimi@caimiexport.it
PEC: caimisrl@pec.it